

Roku Ultra



Quick Start Guide

What's included



Roku Ultra



Remote



Headphones for private listening



Two AA Duracell® batteries



Premium High Speed HDMI® Cable



Power adaptor

Details

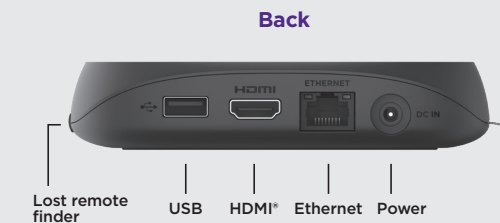
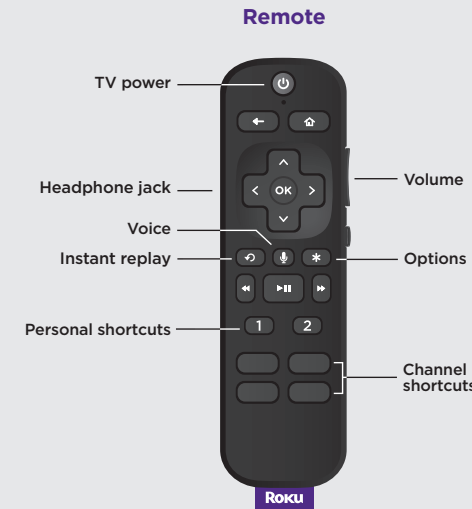

Let's get started

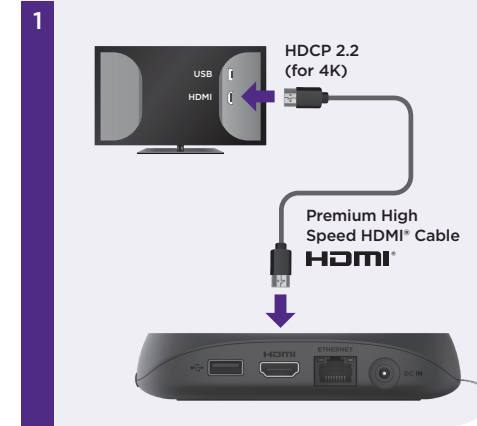

STEP 1: Connect to TV

Connect your streaming player to an HDMI port on the back of your TV with the included cable. For 4K streaming, you'll need to use an HDMI port that supports HDCP 2.2.

TIP:
For help setting up your device, visit [go.roku.com/ultra](https://www.roku.com/ultra)

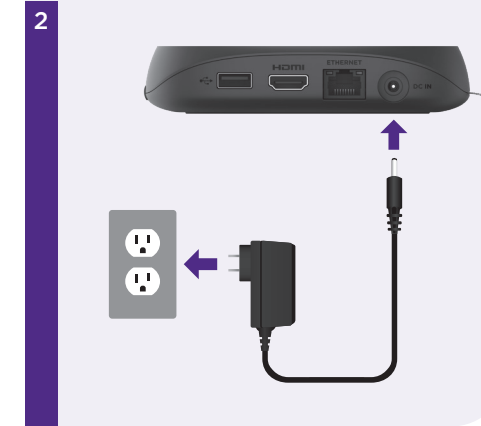

STEP 2: Connect to power

Use the included power adaptor to connect your streaming player to a wall outlet.

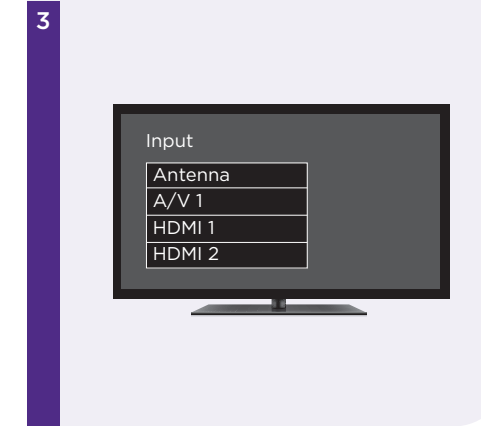

STEP 3: Select input

Use your TV remote to power on your TV and select the input (source) you used to connect your streaming player.



STEP 4: Insert batteries

Slide open the cover on the back of your remote and insert the included Duracell® batteries. Your remote will pair automatically.

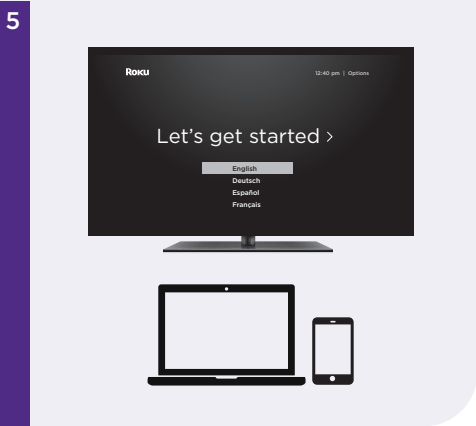

STEP 5: Follow the on-screen setup

Follow the instructions on your TV screen. Activate your streaming player by using your computer or smartphone to link a Roku account.

IMPORTANT:
Roku does not charge for activation support – **beware of scams.**

Remote features

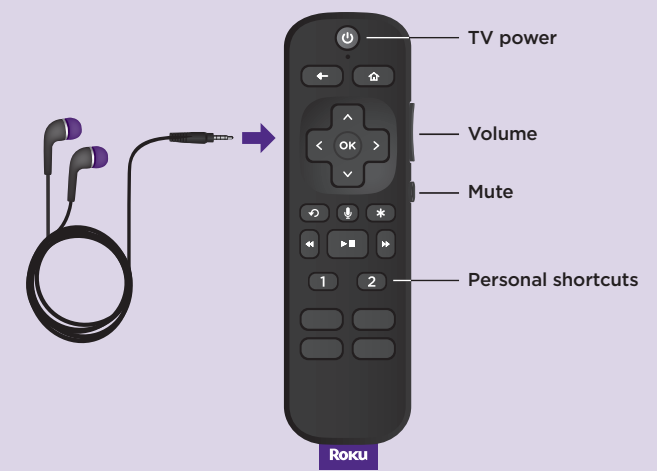

Private listening

To use private listening, simply plug headphones into your remote. Your TV will mute automatically.



TV controls

Use these buttons to power up your TV, adjust the volume, mute, and control your streaming with one remote.



Personal shortcuts

To set: Give a command using the voice button. Then, press and hold a personal shortcut button until you hear a tone.

To use: Press the personal shortcut button once.

Common questions

Why do I need to create a Roku account?

You'll need a Roku account to stream, add channels, easily manage subscriptions, rent movies, and more.

Why should I enter a credit card?

Saving a payment method makes it easy to rent or buy movies, subscribe to popular channels, and start free trials in just a click. No charges will be made without your authorization.

What should I do if my streaming player is not connecting to my wireless network?

Double check the network you selected and that you entered your password correctly. If you have other devices connected to this network, your streaming player should connect.

What type of voice commands can I use with this remote?

“Play classic rock on Pandora”
“Turn captions on”
“Launch The Roku Channel”
“Skip 30 seconds”
“Show me action movies”

Visit go.roku.com/ultra for more information

Need more help?
support.roku.com

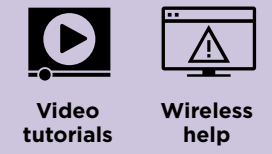

**Cut cable.
Save money.
Stream big.**

streamandsave.com



**See what's streaming
for free, tips, and more**

Visit blog.roku.com



© 2020 Roku, Inc. All rights reserved. ROKU and the ROKU logo are the registered trademarks of Roku, Inc. HDMI, the HDMI logo, and High-Definition Multimedia Interface are the trademarks or registered trademarks of HDMI Licensing, LLC. All other logos and trademarks herein not owned by Roku, Inc. are the property of their respective owners.

