



ENGAGE®

PREMIUM OTC
HEARING AIDS

Android or iOS device
compatible but not required
to use the hearing aids



MANUAL
ENGLISH



**WE'RE HERE TO HELP YOU SET UP YOUR
HEARING AIDS FOR THE BEST FIT & EXPERIENCE**

PHONE: 800-785-6052

EMAIL: customerservice@lucidhearing.com

Welcome Aboard!

We're honored you've chosen to be a part of the Engage family! Our commitment to you is simple:

To help you hear better!

Your journey to better hearing begins now. Every successful journey has a guide to help you get the most out of the adventure! There are two key guides at your disposal. This booklet is a quick and easy reference for you to get started. And for additional details and information, be sure to check out our "how to" video series at [engagehears.com](https://www.engagehears.com)!

Let's get started!

WARNING: If you are younger than 18, do not use this.

You should talk to a doctor, preferably an ear-nose-throat doctor (an ENT), because your condition needs specialized care. Over-the-counter hearing aids are only for users who are age 18 or older.

This OTC hearing aid is for users who are 18 and older. People who are younger than 18 with hearing loss should see a doctor, preferably an ENT, because they may need medical testing and management. Hearing loss can affect speech and learning, so professional fitting and continuing care are also important.

WARNING: When to See a Doctor

If you have any of the problems listed below, please see a doctor, preferably an ear-nose-throat doctor (an ENT).

- Your ear has a birth defect or an unusual shape.
- Your ear was injured or deformed in an accident.
- You saw blood, pus, or fluid coming out of your ear in the past 6 months.
- Your ear feels painful or uncomfortable.

customerservice@lucidhearing.com

- You have a lot of ear wax, or you think something could be in your ear.
- You get really dizzy or have a feeling of spinning or swaying (called vertigo).
- Your hearing changed suddenly in the past 6 months.
- Your hearing changes: it gets worse then gets better again.
- You have worse hearing in one ear.
- You hear ringing or buzzing in only one ear.

WARNING: This hearing aid should not cause pain when inserting it.

Remove this device from your ear if it causes pain or discomfort when you insert or place it. To try again, make sure to follow the instructions. If you feel pain or discomfort again, contact the manufacturer. If your pain or discomfort doesn't go away, contact your hearing healthcare professional. You can also report this to FDA as an adverse event according to the instructions that appear later.

Caution: This is not hearing protection.

You should remove this device if you experience overly loud sounds, whether short or long-lasting. If you're in a loud place, you should use the right kind of hearing protection instead of wearing this device. In general, if you would use ear plugs in a loud place, you should remove this device and use ear plugs.

Caution: The sound output should not be uncomfortable or painful.

You should turn down the volume or remove the device if the sound output is uncomfortably loud or painful. If you consistently need to turn the volume down, you may need to further adjust your device.

Caution: You might need medical help if a piece gets stuck in your ear.

If any part of your hearing aid, like the ear tip, gets stuck in your ear, and you can't easily remove it with your fingers, get medical help as soon as you can. You should not try to use tweezers or cotton swabs because they can push the part farther into your ear, injuring your eardrum or ear canal, possibly seriously.

Note: If you remain concerned, consult a professional.

If you try this device and continue to struggle with or remain concerned about your hearing, you should consult with a hearing healthcare professional.

Note: What you might expect when you start using a hearing aid.

A hearing aid can benefit many people with hearing loss. However, you should know it will not restore normal hearing, and you may still have some difficulty hearing over noise. Further, a hearing aid will not prevent or improve a medical condition that causes hearing loss.

People who start using hearing aids sometimes need a few weeks to get used to them. Similarly, many people find that training or counseling can help them get more out of their devices.

If you have hearing loss in both ears, you might get more out of using hearing aids in both, especially in situations that make you tired from listening—for example, noisy environments.

Note: Tell FDA about injuries, malfunctions, or other adverse events.

To report a problem involving your hearing aid, you should submit information to FDA as soon as possible after the problem. FDA calls them “adverse events,” and they might include: skin irritation in your ear, injury from the device (like cuts or scratches, or burns from an overheated battery), pieces of the device getting stuck in your ear, suddenly worsening hearing loss from using the device, etc.

Instructions for reporting are available at <https://www.fda.gov/Safety/MedWatch>, or call 1-800-FDA-1088.

You can also download a form to mail to the FDA.

CONTENTS

| | |
|--|-------|
| Getting Started..... | 8 |
| What's Inside | 9 |
| Getting to Know Engage | 10 |
| Battery and Tubing..... | 11 |
| Wearing Your New Hearing Aids..... | 12–13 |
| How to Adjust Volume Manually | 14 |
| How to Adjust Profiles Manually | 15 |
| Download the Lucid Hearing App | 16–17 |
| Pairing/Connecting Bluetooth – iOS..... | 18–19 |
| Pairing/Connecting to the App – iOS..... | 20–23 |
| The Lucid Hearing App – iOS..... | 24–25 |
| Pairing/Connecting to the App – Android..... | 30–33 |
| The Lucid Hearing App – Android..... | 34–35 |
| Programs | 40 |
| Audio EQ..... | 41–42 |

| | |
|--|-------|
| LucidShape..... | 43–45 |
| Settings..... | 26–29 |
| Making and Receiving Phone Calls iOS | 42–45 |
| Making and Receiving Phone Calls Android | 46–49 |
| Change or Remove the Concha Lock..... | 50–51 |
| Care and Cleaning Instructions | 52 |
| How to Clean Your Hearing Aids..... | 53 |
| Replacing the Wax Stop | 54–55 |
| Choosing the Correct Ear Tip..... | 56 |
| Replacing the Ear Tips | 57 |
| Replacing the Tubes..... | 58–59 |
| Troubleshooting | 60–61 |
| Technical Data | 62 |
| Warranty..... | 63 |
| Compliance | 64–65 |
| Battery Safety..... | 66–67 |

Getting Started

1. Get familiar with the Engage and what's in the box
2. Download the Lucid Hearing App from the App Store onto your mobile device.
3. Pair the hearing aids to your mobile device
4. Select tips for a perfect fit
5. Put the hearing aids on your ears
6. If fit needs further adjusting, reference the included Engage Tube Fit Guide
7. Listen to what you hear, trying out each of the 4 pre-configured programs
8. Stream some music or make a phone call!



What's Inside

- 1 Pair of Engage Hearing Aids
- 5 Pair Open Ear Tips
- 4 Pair Vented Ear Tips
- 1 Cleaning Tool
- #13 Batteries
- 10 Wax Stops and Replacement Tool
- Engage Tube Fit Guide
- User Manual



Engage Hearing Aids



Hard Case



Open Ear Tips



#13 Batteries



Vented Ear Tips



Wax Stops



Cleaning Tool

Getting to Know Engage

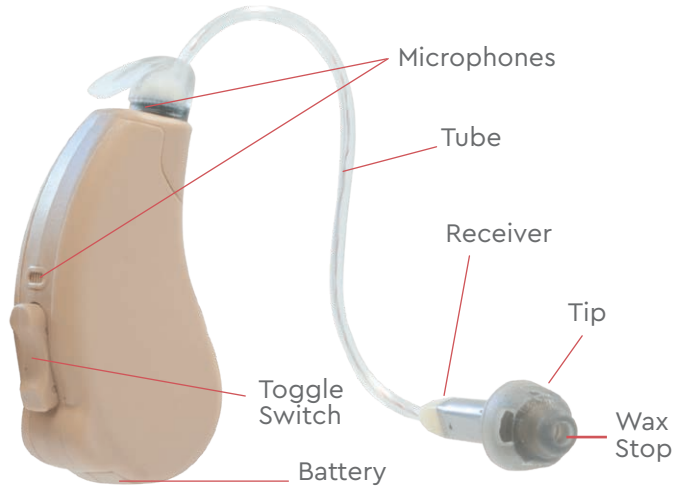

Customer Support 800-785-6052

Batteries

Your hearing aid is powered by a #13 battery and for the best performance we recommend using a zinc-air battery.

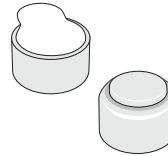

INSERTION: Remove the adhesive label from the battery and wait thirty seconds for the air to activate the battery. Wipe any moisture off the battery surface. Open the battery door and with the positive side up, insert battery into the battery door.



REMOVAL: Open the battery door and lift the battery out of the battery door.

When your battery is low and needs replaced you will hear the low battery voice prompt. The prompt will be repeated every 15–20 minutes until the battery is replaced.

Expected battery life: 4–7 days*

*Based on typical streaming usage of less than 2 hours per day

customerservice@lucidhearing.com

Wearing Your New Hearing Aids

When inserting your hearing aids for the first time, there can be feedback (whistling) if your hearing aids are not fully inserted. We suggest you practice inserting them with the battery door slightly open until you have perfected this process. The adjustment period of wearing hearing aids takes time, but soon you'll be hearing clearly.

The following steps show how to insert your hearing aids:

- 1 Grasp hearing aid between your thumb and forefinger

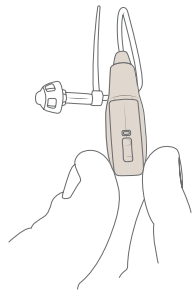

- 2 Place hearing aid behind ear, with tube pointed forward over ear



- 3 The tube is wrapped around the top of ear. Gently push the ear tip into the ear canal

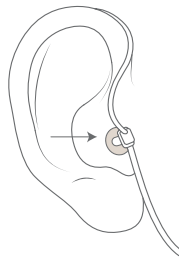

- 4 Tuck the concha lock into the bowl of the ear



If at this point you feel the fit isn't right please refer to the included Engage Tube Fit Guide for guidance. Our customer service team can assist you and send you the right size tubes to help you find your perfect fit.

How to Adjust Volume Manually

You can adjust the hearing aids manually with the toggle switch. A quick press of the toggle switch **UP** or **DOWN** will adjust the volume up/down. You will hear double tones indicating the volume has been adjusted. If you do not hear tones, this indicates you have reached the maximum or minimum volume level.

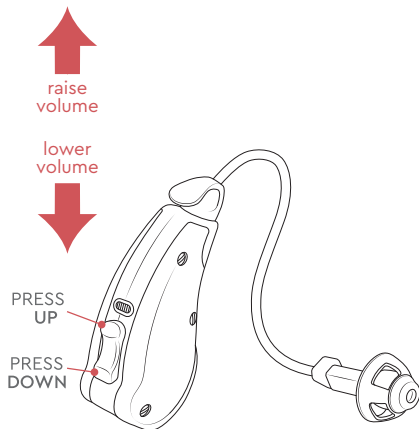

The easiest way to adjust your hearing aids is with the Lucid Hearing App (See page 16).

Customer Support 800-785-6052

How to Change Profiles Manually

Press and hold the toggle switch **UP** or **DOWN** for 2 seconds to progress to a different program.

You will hear a notification alerting you that you are on a different program. Press and hold again to cycle through the programs.

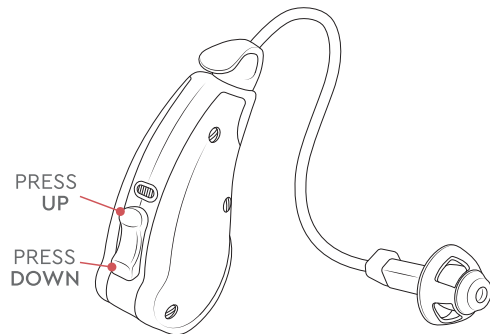

The easiest way to adjust your hearing aids is with the Lucid Hearing App (See page 16).

customerservice@lucidhearing.com

Download the Lucid Hearing App®



Comprehensive real-time personalization with the ability to manage acoustic volume across any listening environment.

With the Lucid Hearing App and Engage, you can:

- Explore and select your preferred hearing program
- Monitor the battery status of your hearing aids

With LucidShape and Engage, you can:

- Fine-tune your listening for the most customized experience
- Control the left and right hearing aids together or independently

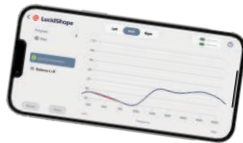

For ease, use your phone camera to scan this code to download either the Apple or Android app, depending on which device you have.

You can also search for "Lucid Hearing" in the App Store or on Google Play.



Pairing/Connecting Hearing Aids to Your Device's Bluetooth®

1. Remove hearing aids from the charging case
2. On your phone, go to → Settings
3. Go to → Accessibility
4. Go to → Hearing Devices
 - For best results, unpair any other hearing aid devices that appear before continuing to pair Engage.
5. "Device Name" or "UserName's HA" should appear, click on this tab
6. Prompt will appear asking to pair twice. Click on **Pair** each time.
7. Hearing aids should now read as connected and are successfully paired.

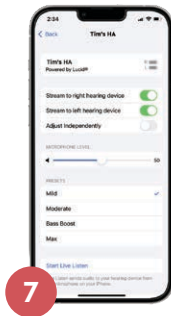
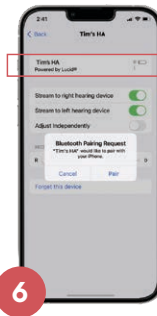
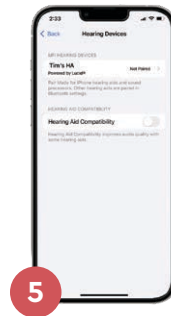
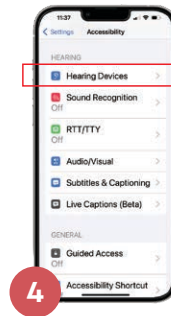
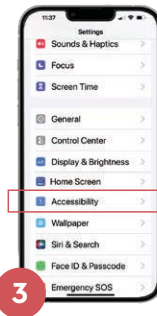

Pairing/Connecting to the Lucid Hearing App

Open the app and follow these steps:

Once your app is downloaded, open the app and your first screen will be a welcome screen. Click on **Start Using Lucid Hearing** and begin the sign-up process.

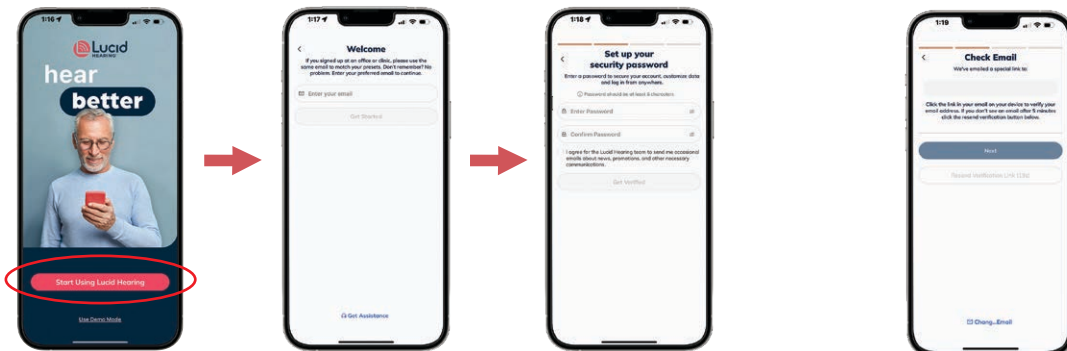

Customers with a current Lucid Hearing account:

Use the email associated with your profile. If you already have a password set up, log in and enter that password. If you do not have a password currently set up, then create a new password to protect your account.

Customers without a current Lucid Hearing account:

If this is your first time as a customer, use any email you prefer. After creating a password, the system will generate an email to confirm your account. Check your junk mail if you don't see it.

(cont'd)

Once you've received the email and clicked on the link to confirm, you're ready to create your account and start navigating the app.

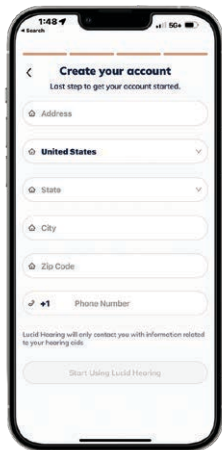
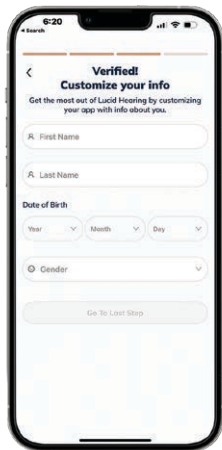

Customer Support 800-785-6052

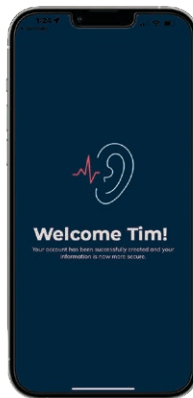

Once complete, you'll be greeted by a welcome screen.

Within the Lucid Hearing App, your hearing aids will appear on the **Pair Your Device** screen.



Pairing: Your hearing aids should be charged and taken out of their case to power on. Check the box, then click **Pair** at the bottom of the screen.

customerservice@lucidhearing.com

The Lucid Hearing App

Your app will automatically open to the **Volume** screen where you can adjust the volume of both hearing aids together. To adjust independently toggle the **Both** switch off.

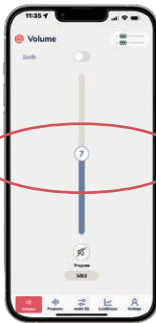

▶ The app will always set the volume to the middle level upon start up or resetting the hearing aids.

Toggle the switch to the right to allow independent control. Slide the bar up and down to control volume or click  to mute your aids if needed.

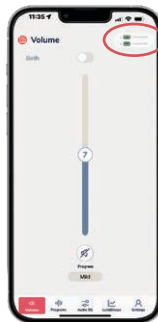
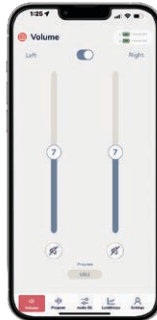

▶ **Hearing Aid Status:** In the top right corner of the **Volume** screen you will see the green and white battery icon box.

By clicking on this box, it will show your connected hearing aids and their battery level charge. To exit the screen, click **Close**.



Continue to page 32

Pairing/Connecting to the Lucid Hearing App

Open the app and follow these steps:



◀ Once your app is downloaded, open the app and your first screen will be a welcome screen. Click on **Start Using Lucid Hearing** and begin the sign-up process.

▶ **Customers with a current Lucid Hearing account:**

Use the email associated with your profile.

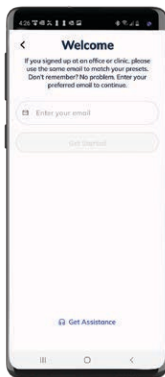

Customer Support 800-785-6052

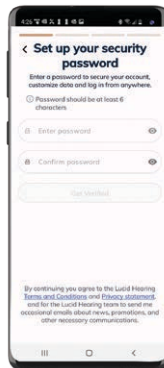

◀ If you already have a password set up, log in and enter that password. If you do not have a password currently set up, then create a new password to protect your account.

▶ **Customers without a current Lucid Hearing account:**

If this is your first time as a customer, use any email you prefer. After creating a password, the system will generate an email to confirm your account. Check your junk mail if you don't see it.

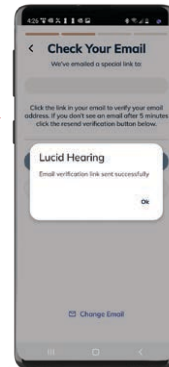

customerservice@lucidhearing.com

(cont'd)

Once you've received the email and clicked on the link to confirm, you're ready to create your account and start navigating the app.

Once complete, you'll be greeted by a welcome screen.

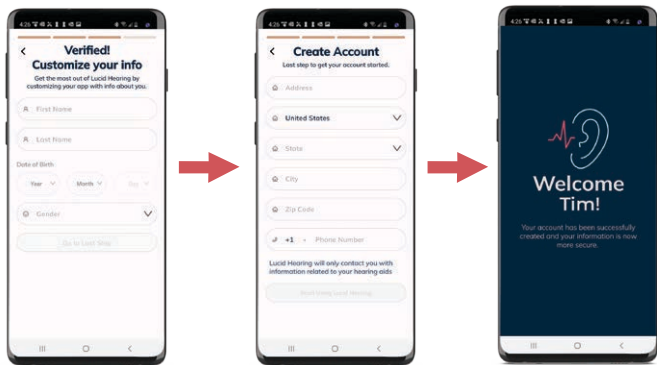

Customer Support 800-785-6052

Pairing: Your hearing aids should be charged and taken out of their case to power on.

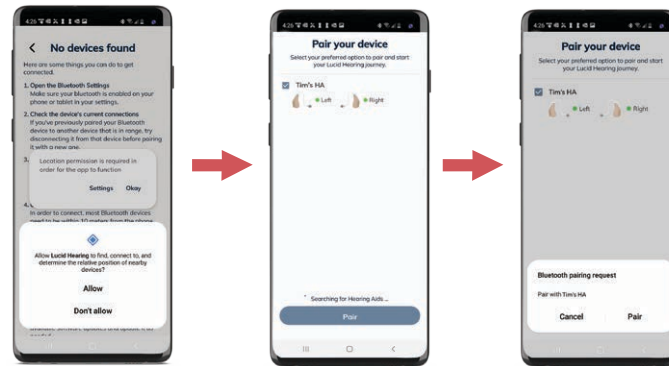

Accept the app permissions to find nearby devices.

Within the Lucid Hearing App, your hearing aids will appear on the **Pair Your Device** screen.

customerservice@lucidhearing.com

The Lucid Hearing App

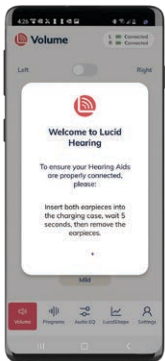

After pairing your hearing aids, a prompt will ask you to insert the devices into the charging case and then remove them.

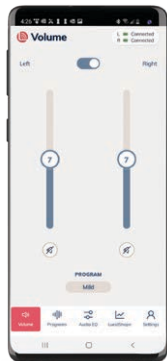

Next, the Volume screen will allow you to adjust the volume of both hearing aids together.



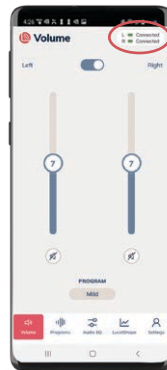

To adjust independently, toggle the Both switch off. Slide the bar up and down to control volume or click  to mute your aids if needed.

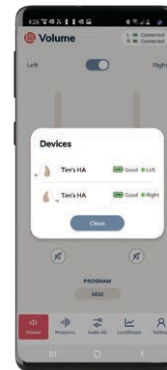

Hearing Aid Status: In the top right corner of the **Volume** screen you will see the green and white battery icon box.

By clicking on this  box, it will show your connected hearing aids and their battery level charge. To exit the screen, click **Close**.



The remaining instructions apply to **both**  **and** **Android**  **devices.**

Programs

On the **Programs** tab, you will select the desired listening profile for your hearing aids. You can select the same program for both, or select a unique setting for each individual side.

The **Both** setting will appear when both hearing aids are set to the same program and disappear when unique programs are selected.

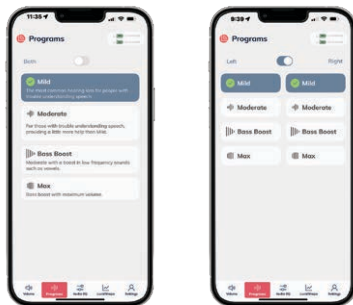

Both

Individual

The **Programs** tab will allow you to change between listening settings pre-programmed for your convenience. Explore programs for both aids, or toggle to allow independent control of the left and right aid if needed.

Audio EQ

The **Audio EQ** offers two very useful features. Explore **Audio Mix** and the **Audio Equalizer** sections below to learn how to customize your listening experience.

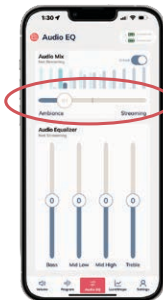

Audio Mix

The **Audio Mix** allows you to balance ambiance with streaming volume in real-time. Drag the switch to the right to hear more of what you're streaming and less ambient background noise, or drag it further to the left to allow more environmental awareness and less audio signal.

Audio EQ (cont'd)

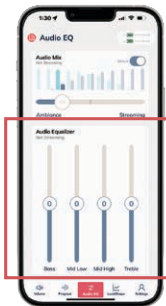

Audio Equalizer

The **Audio Equalizer** allows you to manipulate four independent frequency ranges (Bass, Mid Low, Mid High, Treble) designed to customize or fine tune your individual streaming preference. You achieve this by simply touching the slide bar and sliding it to the desired position.



Unlock/Lock

To adjust the audio while media is paused or stopped, unlock by sliding the toggle switch next to the Audio Mix. Your changes will be made once you resume listening.

Customer Support 800-785-6052

Using LucidShape



LucidShape®

Lucid Hearing App
featuring LucidShape

LucidShape gives you the ability to adjust specific frequencies according to your listening preferences and needs. Here we will demonstrate how to use LucidShape to adjust your hearing aids.

First, select which hearing aid you would like to adjust at the top of the screen. You can choose to adjust the **left and right individually, or both** together. LucidShape automatically defaults to both.



customerservice@lucidhearing.com

Using LucidShape (cont'd)



Live Environment mode:
Listen to the environment around you as you begin to adjust your listening program.



Balance L+R mode:
Both left and right hearing aids will play a tone simultaneously to help you adjust the balance between the hearing aids.

Note that when you open Lucidshape you are automatically adjusting the program you are currently in, but you can manually select to a different program.

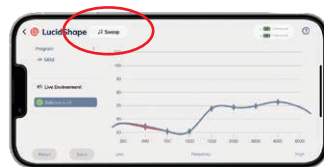

Sweep button:
Within the **L+R** screen, press **Sweep** to run through all the frequencies and play tones from low to high. Listen to each frequency and make adjustments to volume as needed. You can also use the **Balance L+R** screen to touch an individual frequency, which will play that tone as you adjust the volume at that frequency.



To increase volume and sensitivity, just press, hold and drag **upwards**. To decrease volume and sensitivity, **drag down**.

Reset
Save

Once you are satisfied with the sound, click **Save** at the bottom left of the screen.

To start over, click **Reset** and your hearing aids will be reset to their original setting.

customerservice@lucidhearing.com

Customer Support 800-785-6052

Settings

Here you will find information about your hearing aids, a helpful **User Guide** for the Lucid Hearing App, LucidShape and support.

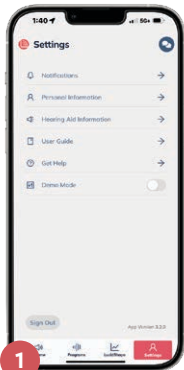

1. Settings: From the Settings home screen, you'll find access to numerous tabs to support your Lucid Hearing journey.

2. Notifications: On the Notifications tab, you'll access messages about your product and hearing health. These may include appointment reminders, cleaning tips, or important updates.

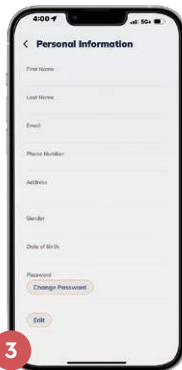
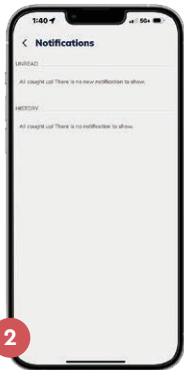

3. Personal Information: Use the Personal Information screen to store and edit your information such as address, phone number, and password.

4. Hearing Aid Information: From this screen, can view firmware information, view the model of your hearing aids, as well as disconnect your hearing aids from the app. To disconnect, scroll to the bottom of the screen and select **Change or Disconnect**. This will unpair your current hearing aids with the app.

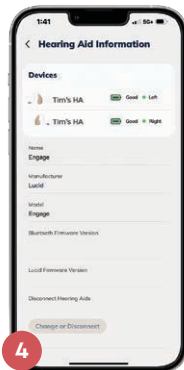

Settings (cont'd)

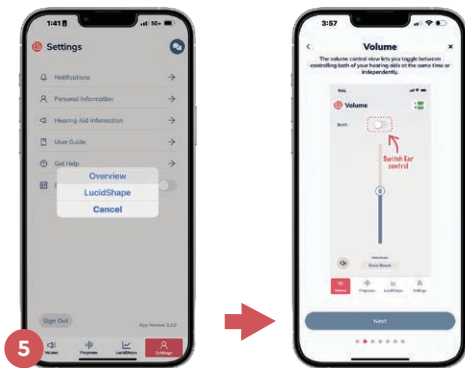

5. User Guide: This helpful screen will walk you through all the features of the Lucid Hearing App. Click **Next** to learn how to manage programs, volume and more. Revisit this screen anytime you need a refresher.

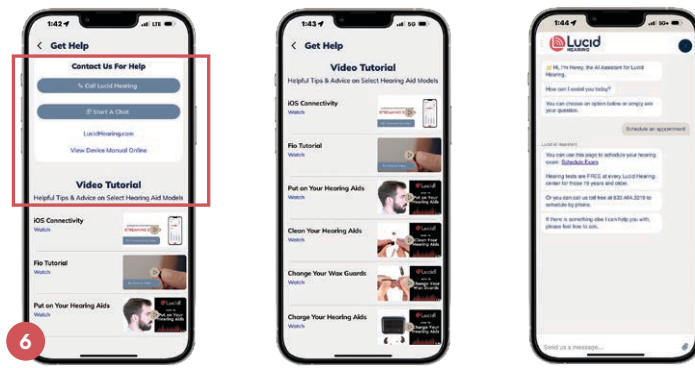

6. Get Help: You're never alone with Lucid Hearing. We understand that you may occasionally have questions and need support with your hearing aids. In this section, you'll be able to **call our live support team (available Mon-Sat 8:00 a.m. to 6 pm Central), chat with a virtual agent, and access our library of guided video tutorials.** Help is just a click away!

Making and Receiving Phone Calls

Your hearing aids offer seamless connectivity to your smartphone, allowing you to effortlessly make and receive phone calls, enjoy music, and listen to other audio content directly through your hearing aids.



Customer Support 800-785-6052

Making Calls

1. Open your smartphone's dialer or select a contact you want to call.
2. Once you've chosen a number or contact, your hearing aids will automatically connect to your phone.
3. A prompt will appear on your smartphone screen, giving you the option to select your audio output. Choose either your hearing aids or your phone as your preferred audio source.
4. Ensure that your smartphone remains within the Bluetooth range to utilize its microphone for the conversation.

Receiving Calls

1. When you receive an incoming call, your hearing aids will seamlessly connect to the call.
2. Your smartphone's call screen will display options for managing the call. You can switch between hearing the call through your hearing aids or your phone by adjusting the audio source on the call screen.

customerservice@lucidhearing.com

Making and Receiving Phone Calls (cont'd)

You can manage your call settings in your phone by following these steps:

In **Hearing Devices** located in settings you can choose how your phone and hearing aids receive calls.



1. Go to
Audio Routing

2. Select
Call Audio

3. Select one
of 3 options

Call Audio Options:

Always Hearing Aids: Audio will always be routed to the hearing aids by default, even if the Apple device is connected to other Bluetooth devices (e.g. speaker, car).

Never Hearing Aids: Audio will never route to the hearing aids by default, rather than other connected Bluetooth devices or the Apple device itself.

Automatic: Audio will often route to the most recent Bluetooth connection or the longest standing Bluetooth device. Performance may vary.

Making and Receiving Phone Calls

Your hearing aids offer seamless connectivity to your smartphone, allowing you to effortlessly make and receive phone calls, enjoy music, and listen to other audio content directly through your hearing aids.



Making Calls

1. Open your smartphone's dialer or select a contact you want to call.
2. Once your call is initiated, your hearing aids will automatically connect to your phone.
3. Ensure that your smartphone remains within the Bluetooth range to utilize its microphone for the conversation.

Receiving Calls

1. When you receive an incoming call, your hearing aids will seamlessly connect to the call.

Making and Receiving Phone Calls (cont'd)

To disconnect your hearing aids from calls:

1. Swipe down from the top of your home screen.
2. You will see Bluetooth icon at the top of the screen. Long press it.
3. After that you should see a list of connected devices. Press the gear icon next to your hearing aids.
4. You will see a switch for phone calls to toggle on and off.

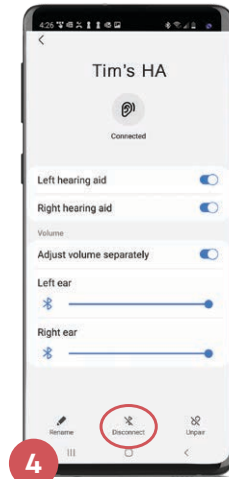
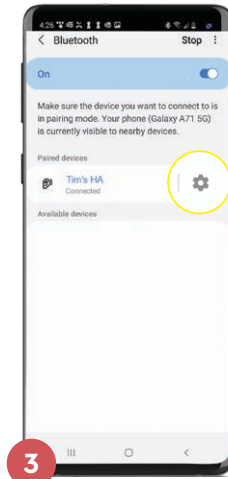
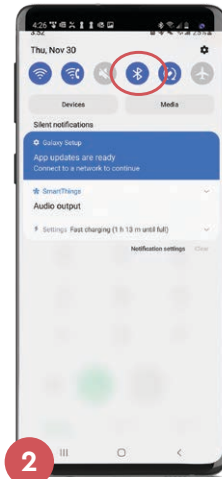

Note : Android screen may vary according to device.

How to Change or Remove the Concha Lock

The Concha Lock attaches to the receiver to position the receiver securely in the ear. If a new Concha Lock is needed for comfort or fit, they can be ordered at [engagehears.com](https://www.engagehears.com) or call 866-202-2527.

Instructions for removing/replacing the Concha Lock:

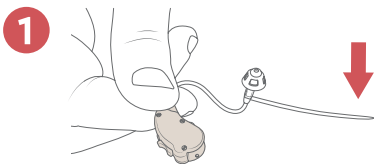

1 Locate the Concha Lock.

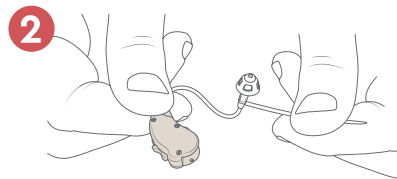

2 Grasp the Concha Lock with thumb and forefinger.

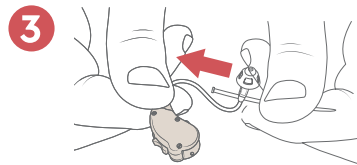

3 The Concha Lock is held tightly to the receiver by a small, plastic loop. Firmly push the Concha Lock back through loop.



4 Once the Concha Lock is removed, a new one can be installed.

Care and Cleaning Instructions

To ensure your hearing aids continue to work properly for years to come please note that you should avoid submerging in water, dropping from distances greater than 3 feet, or exposing to excessive heat for extended periods of time.



The most common cause of instrument failure is wax buildup and it is the easiest to avoid. By wiping your hearing aids, tubing, sound tip, ear tips and/or domes with a soft, dry cloth every day and carefully removing any traces of wax and debris, you will reduce wax buildup. Use the brush provided to enhance your cleaning by lightly brushing the sound ports. It is important to keep your hearing aids as clean as possible to maintain maximum performance and durability.



Important: Keep your hearing aids as clean as possible to maintain maximum performance.

Customer Support 800-785-6052

How to Clean Your Hearing Aids

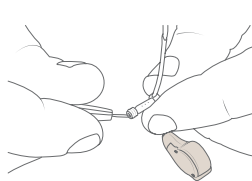
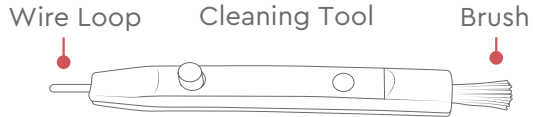

Use wire loop to clean wax from tips

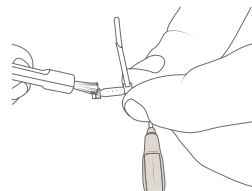

Use brush to clean off wax and dirt



Brush microphone openings

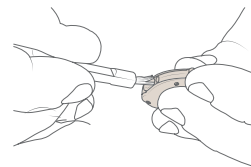

Brush around rocker switch

customerservice@lucidhearing.com

Replacing Wax Stop

Your Engage Hearing Aids have a wax stop in the tip to prevent wax from getting inside the speaker. You should check daily for any obstruction to the wax stop. If you see wax inside you can replace it using the instructions on the next page.

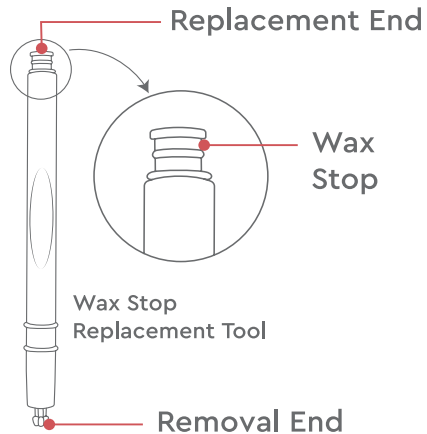

Warning: Improper replacement could result in the wax stop coming out of the receiver and being lodged in the ear canal.

Customer Support 800-785-6052

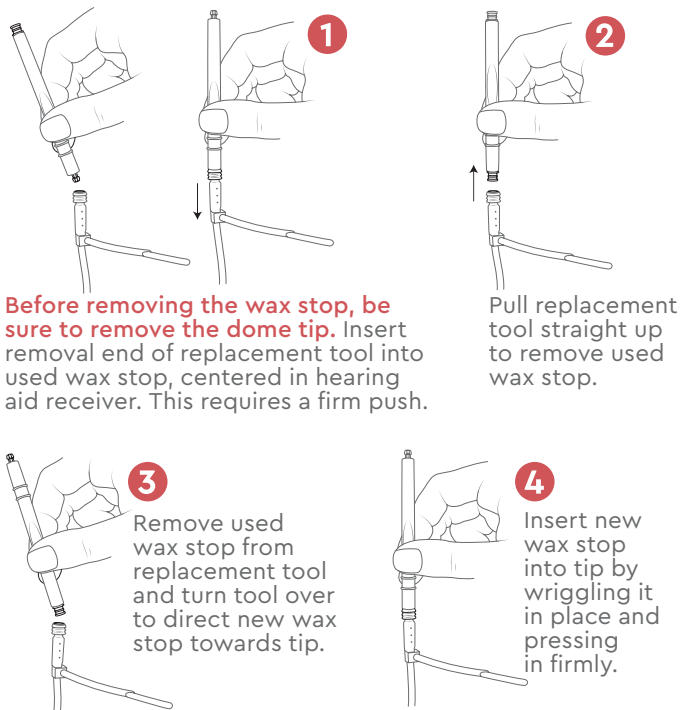

Before removing the wax stop, be sure to remove the dome tip. Insert removal end of replacement tool into used wax stop, centered in hearing aid receiver. This requires a firm push.

Pull replacement tool straight up to remove used wax stop.

Remove used wax stop from replacement tool and turn tool over to direct new wax stop towards tip.

Insert new wax stop into tip by wiggling it in place and pressing in firmly.

customerservice@lucidhearing.com

Choosing the Correct Ear Tip

We have included a number of different dome tips for you to find the perfect fit. The tip should fit snugly enough to seal the ear, while not being uncomfortably too tight. Some experimentation may be necessary. You will notice there are two types of tips included.

OPEN



Open tips provide the best experience for streaming music and phone calls and provide a full, rich sound. They provide better amplification than the vented tips and can help minimize feedback, but may require a little longer to adjust to the sound of your own voice when you first start wearing them.

VENTED



Vented tips can be more comfortable for those with mild hearing loss. They allow more of your own voice to pass through, but do not provide as rich of a sound experience when streaming audio from your phone.

Customer Support 800-785-6052

Replacing the Ear Tips

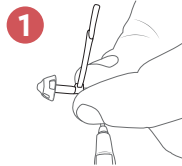

Hold the hearing aid by the base of the speaker housing.

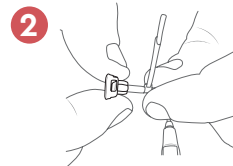

Gently pull on the tip until it comes off. You may need to twist it using a back and forth motion.

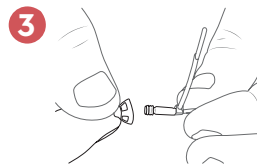

Align the new tip with the dome facing outward.

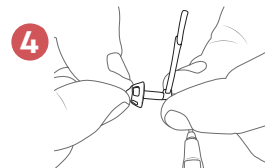

Press the new tip onto the speaker housing until the wax stop is flush with the entrance to the dome tip.



Note: Improper replacement of ear tips could result in the ear tip coming off of the device and being lodged in the ear canal.

customerservice@lucidhearing.com

Replacing the Tubes

REMOVAL:

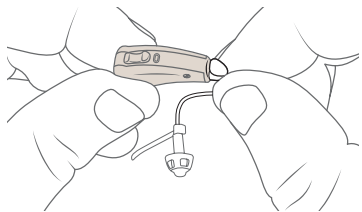

Grip the old tube on the sides of the clear plastic connector firmly.

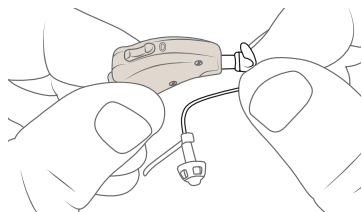

Pull tube straight out until fully detached. Do not twist or pull on the flexible tube itself.

ATTACHING:

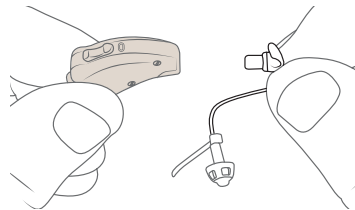

To replace the tube align the base of the tube with the hearing aid connector and press firmly to insert until you hear a click.



Note: Improper removal or insertion of the tubes could result in damage the tube and/or the device.

Troubleshooting

| ISSUE | POSSIBLE CAUSE | SOLUTIONS |
|---------------------|--------------------------------------|---|
| No/Low sound output | Low battery | Replace battery with a new #13 battery |
| | Wax build up in the wax stop | Clean or replace the dome |
| | Volume set too low | Use the app to increase the volume to a comfortable level |
| | Tip not inserted properly | Re-insert the tip |
| | Hearing aid is damaged | Contact Lucid Hearing Customer Service |
| | A significant change in your hearing | Contact your hearing health care professional for an exam. Lucid Hearing Customer Service can recommend a specialist in your area |

| ISSUE | POSSIBLE CAUSE | SOLUTIONS |
|------------------------------|---------------------------------------|--|
| Whistling/ Feedback | Tip not inserted properly | Reinsert hearing aid tip |
| | Dome tip damaged or is the wrong size | Replace dome tip with a new tip |
| | Wax build-up in the ear canal | Talk to your doctor or a hearing healthcare professional about how to best clean your ears |
| Hearing aids not turning off | Battery door closed | Open battery door |
| Device is not comfortable | Tip is too large or too small | Try a different size dome tip |
| | Tube is too large or too small | See Tube Fit Guide (included) |

Still have issues? Reach out to us at **800-785-6052** or chat with us at **lucidhearing.com** and our specialists will be happy to help you.

Your satisfaction is our number one priority!

Technical Data

ANSI TEST

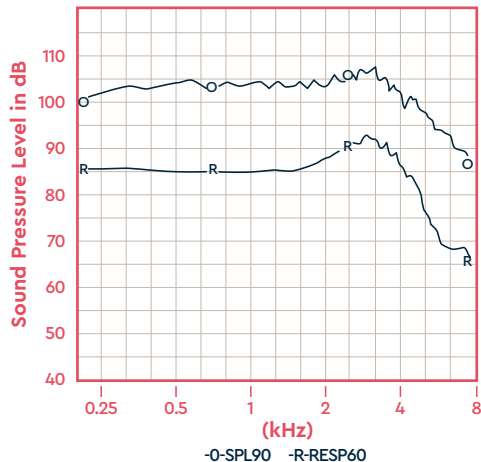

Linear FOG@50 dB
OSPL90 Max 107.1 dB
@ 3200 Hz
SPA 104.1 dB
SPA FOG @ 50 27.8 dB
RTG TARGET 27.1 dB
Measured 28.1 dB
EQ_Insp noise 29.6 dB
Resp limit 68.1 dB
F1< 200 Hz F2=7622 Hz

HFA 1250, 2000, 3150 Hz

| Freq | THDist | Src |
|--------|--------|-------|
| 650Hz | 0.3% | 70 dB |
| 1000Hz | 0.4% | 70 dB |
| 1600Hz | 0.3% | 65 dB |

Latency < 2.75 msec

Battery Drain 2.5mA
non-streaming

Warranty

Lucid Hearing OTC products are risk free with a 60 day return period and a 1 year manufacturer's warranty. To file a claim please call us at 866-458-8947.



Warranty Warning: Please do not attempt to make repairs yourself. Doing so could cause additional damage and will void any warranties.

- **Remove** batteries when hearing aids will not be in use for prolonged periods of time.
- **Do not throw** or drop your instruments.
- **Do not immerse** hearing instruments in liquid or water.
- **Do not wear** during bathing, showering, or swimming.
- **Store out of the reach of children and pets.**
- **Do not expose** instruments to excessive heat, such as a stove top, microwave, dashboard of a hot car, or hair dryer.
- **Do not expose** the instruments to chemicals such as hair spray, insect repellent, perfume, or cosmetics.
- **Do not** use the product with higher volume for a long period of time, in order to avoid hearing damage. Stop using if discomfort occurs.
- **Do not disassemble** the device.
- **Avoid use in potential explosive** or dangerous situations.
- **To avoid possible electromagnetic radiation**, the devices should be removed in any high frequency, heat treatment or operation, radiotherapy and strong magnetic field environments.

customerservice@lucidhearing.com

Customer Support 800-785-6052

Compliance

FCC statement

This device complies with Part 15 of the FCC Rules.

Operation is subject to the following two conditions:

- (1) This device may not cause harmful interference, and;
- (2) This device must accept any interference received, including interference that may cause undesired operation

FCC ID: 2AC2WSQ-U56

FCC Regulator Statements

This device complies with Part 15 of the FCC Rules, Operation is subject to the following two conditions: (1) this device may not cause harmful interference, and (2) this device must accept any interference received, including interference that may cause undesired operation.

NOTE: THE GRANTEE IS NOT RESPONSIBLE FOR ANY CHANGES OR MODIFICATIONS NOT EXPRESSLY APPROVED BY THE PARTY RESPONSIBLE FOR COMPLIANCE SUCH MODIFICATIONS COULD VOID THE USER'S AUTHORITY TO OPERATE THE EQUIPMENT.

Environmental Conditions

During transport or storage, the temperatures should not exceed the limit value of -25° to 70°C, (-13° to 158°F) 0 to 90%, 700 hPa to 1060 hPa.

Battery should be removed from the device while transporting or storing. Operating Condition: your hearing instruments are designed to operate beyond the range of temperature comfortable to you, from very cold to 50C (122F)



Manufactured by:

Sound Quest, LLC
806 Beaver Street
Bristol, Pa 19007

Distributed by:

Lucid Hearing Holding Company, LLC
PO BOX 535596
Grand Prairie, TX 75053

Transport & Storage



0 to 90%
700 hPa to 1060 hPa

Operational Conditions



15-90% RH non-condensing
700hPa to 1060 hPa

IP22 Protection against dripping water at all angles
Protection against objects ≥ 12.5 mm in diameter



Type B applied part



Read Instructions

Customer Support 800-785-6052

customerservice@lucidhearing.com

Battery Safety



CAUTION – Battery Safety Information **Hearing Aid Batteries are Dangerous if Swallowed**

Keep hearing aids out of the reach of children or anyone who may accidentally swallow them. Never put hearing aids in your mouth for any reason. Do not store in pill containers where they may be mistaken for medication and swallowed. Do not attempt to remove batteries from your device, see your hearing care professional. Do not use any other rechargeable battery; Batteries of low quality may leak and cause bodily harm. Batteries with incorrect voltage may cause damage to your device. They may explode and cause serious injury. Do not expose your hearing aid to heat, such as an open flame, microwave, or oven. There is a risk that they will explode and cause serious injury.

Visit <http://www.poison.org/prevent/battery.asp> to learn more important information about battery safety.

If a battery or hearing instrument is swallowed, see a doctor immediately and call the National Capital Poison Center, 202-625-3333.



Disposal of Instruments
Waste from electronic equipment must be handled according to local regulations.



WARNING: Risk of Fire and Burns. Do not Open, Crush, Heat above 60°C/131°F or incinerate. Do not short circuit. If bulges severely, discontinue use.



Register your Lucid Hearing device to get faster tech support, notifications, exclusive news, warranty info and more.



Scan QR Code to register your product or visit
lucidhearing.com/warranty

©2024 Lucid Hearing Holding Company, LLC. Lucid Hearing and Engage are registered trademarks of Lucid Hearing Holding Company, LLC. LucidShape is a trademark of Lucid Hearing Holding Company, LLC. Apple and iPhone are trademarks of Apple Inc., registered in the U.S. and other countries. Android is a trademark of Google LLC. Google Play and the Google Play logo are trademarks of Google LLC. All rights reserved.