

Check Your Resin Consistency:



• Is your epoxy grainy, solidified or cloudy like images 1-3? If so, what you have is crystallized resin. This process is similar to what happens to honey when it sits on the shelf for a long time. If partially crystallized resin is mixed with the hardener, the resulting material will be either soft or uncured.

• Crystallization occurs most often when the product is exposed to low temperatures. Our products are formulated to resist crystallization, but it can still occur.

Restore Casting Resin:

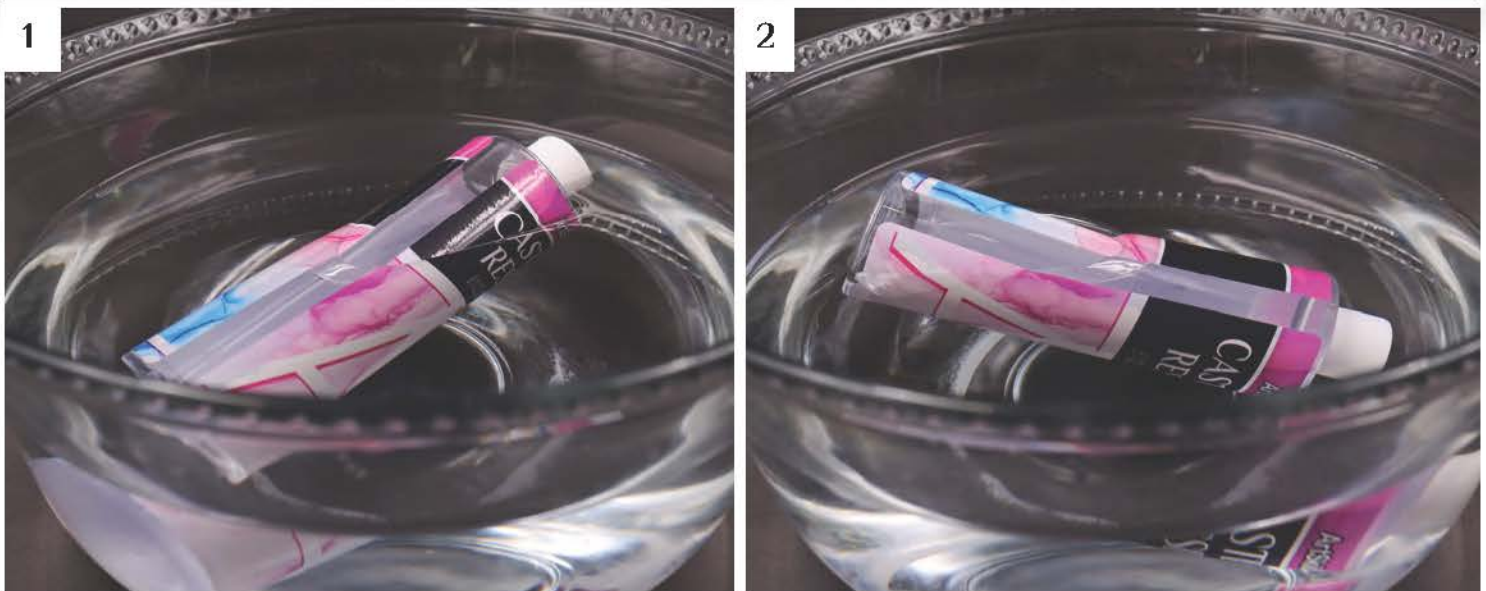

• The best way to return the resin to its original state is to submerge the bottle completely in hot tap water.

• Inspect and clean the outside of the bottle before putting it in the water, making sure that the cap is on tight. Then place the bottle into the water for an extended period of time. Agitate and turn the bottle periodically.

• The length of time the bottle is submerged may vary depending on the crystallization period of the resin (may take from 1 to 3 hours – replenish hot water as needed). Do not remove resin from water until all crystals have melted and it is completely clear.

Inspect Purity of Restored Resin:



- Casting resin should appear clear and smooth, similar to the consistency of Resin Hardener B. If crystallization reoccurs, the bottle was not submerged in warm water long enough to return to its original state.
- Once the resin has returned to a clear, flowing state, remove the bottle and wipe with a paper towel.

Ready to Use Resin:



- Your resin is now ready to use as instructed in the kit's original instruction sheet.
- To prevent crystallization in the future, store your resin at room temperature.