

Traditional Living Flooring Install Instructions

Tools Required for Installation

Common Tools

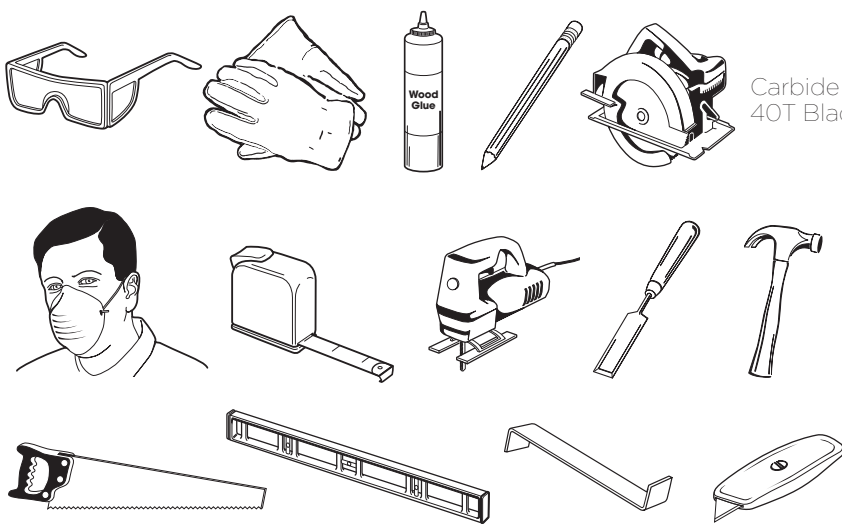

Carbide 40T Blade

Other Tools and Supplies

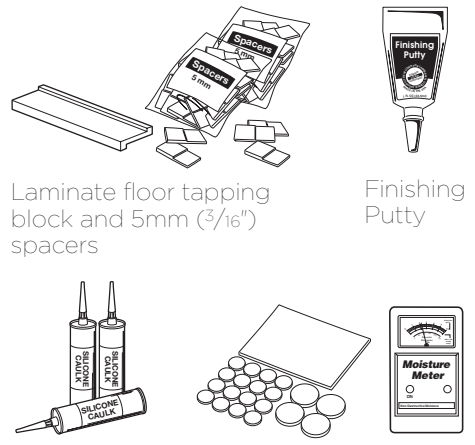

Laminate floor tapping block and 5mm (3/16") spacers

Finishing Putty

Mildew-resistant silicone

Felt furniture pads

Moisture Meter

Job Site

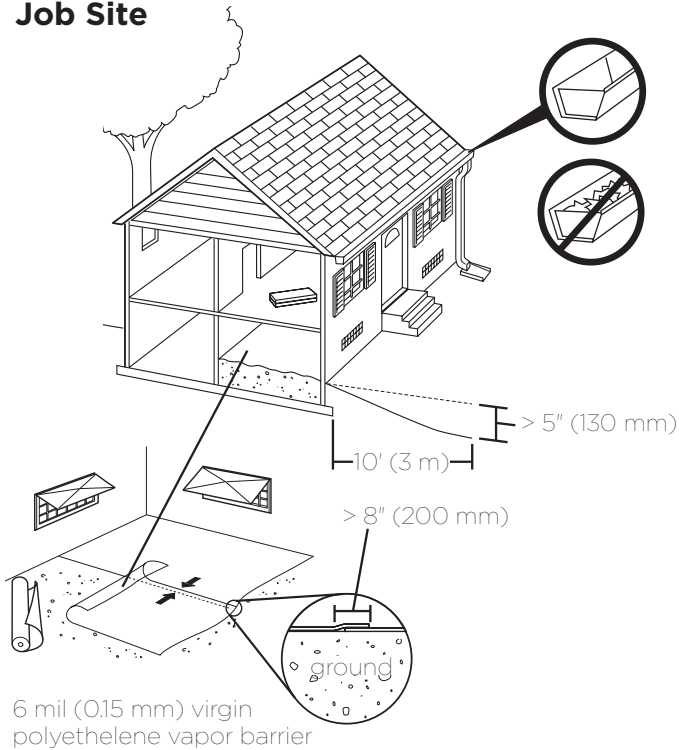

Site Requirements

Laminate is a durable floor covering, not intended as structural material. Laminate requires a clean, dry, secure subfloor that meets building codes.

Laminate floor is suitable for use in climate controlled (35-65% RH and 60-85° F) indoor installations only and should not be installed in rooms with floor drains or sump pumps. Laminate floor can be installed above, on or below grade.

A moisture test is strongly recommended to determine if high moisture exists in the subfloor. When using a calcium chloride moisture test for concrete subfloors (ASTM 1869), values must be ≤ 5 lbs/1000ft²/24-hr or $<80\%$ with an in situ probe (ASTM F2170). Moisture readings of wood subfloors must be $\leq 12\%$.

Acceptable job site conditions, including relative humidity and subfloor moisture conditions, must be maintained throughout the lifetime of the flooring.

Laminate flooring is installed as a floating floor and requires the use of T-moldings in doorways 4 ft (1.22m) or less and in rooms 40 feet (12.2 m) or larger in length or width. Floor movement must not be constrained by glue, nails, screws, hardware or other fixed obstructions.

This product must be installed in accordance with these installation instructions.

For more information, call 1-800-325-7062

Traditional Living Flooring Install Instructions

Site and Material Preparation

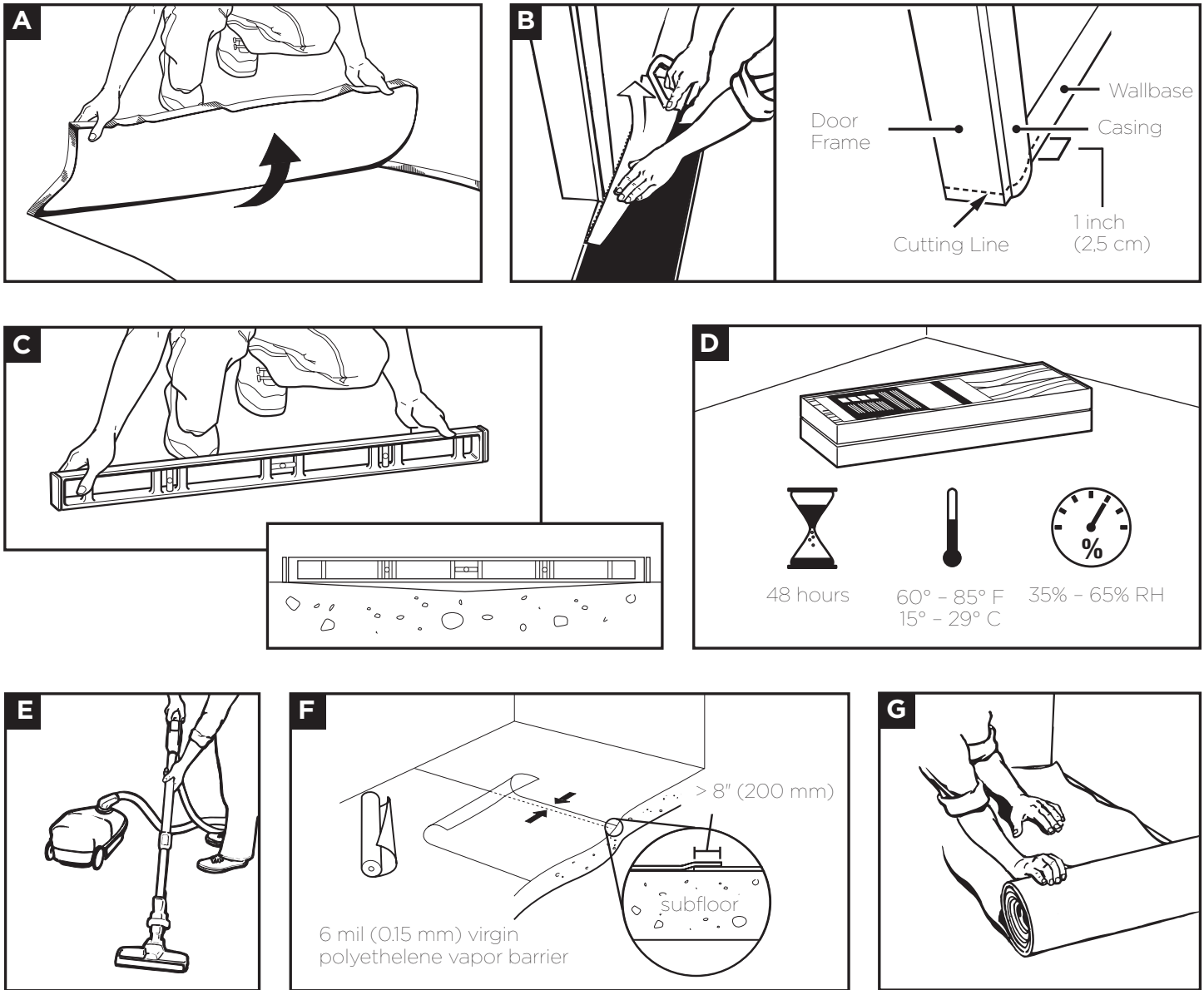

Site and Material Preparation

- Remove carpet and padding. Also remove any wood flooring installed on concrete. Do not remove products unless they are asbestos-free.
- Undercut door frame and wallbase. Slide the flooring at least $\frac{1}{4}$ " underneath the door frame and wallbase. Also leave a concealed $\frac{3}{8}$ " minimum expansion space under each.
- Remove bumps or peaks in subfloor and fill depressions with floor leveling compound to ensure no more than $\frac{3}{16}$ " unevenness per 10-foot span.
- Acclimate unopened product before installation.
- Clean debris from subfloor before installation.
- For concrete subfloors, install vapor barrier with **overlapped** seams of 8" or more.
- For planks without attached underlayment**, install over single layer of underlayment appropriate for laminate floors.

Traditional Living Flooring Install Instructions

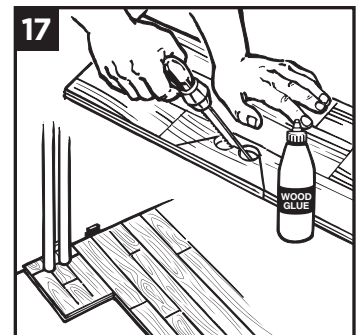
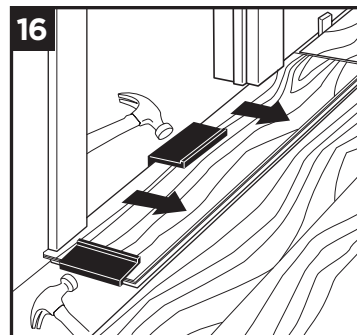
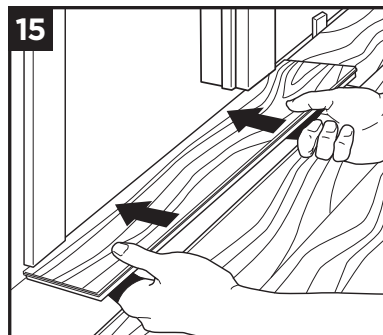
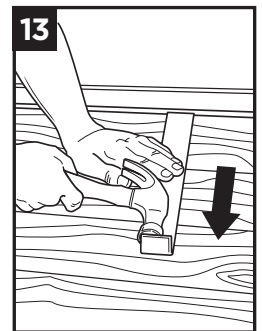
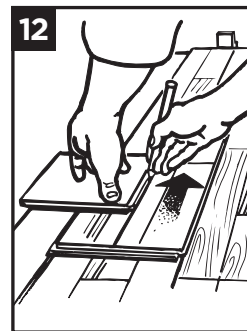
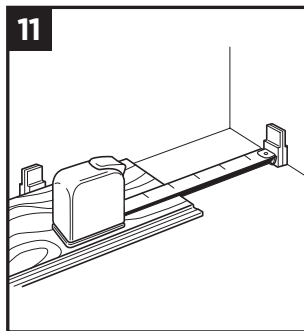
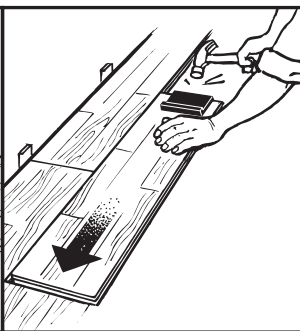
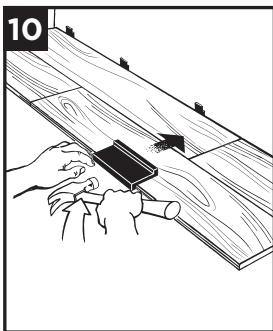
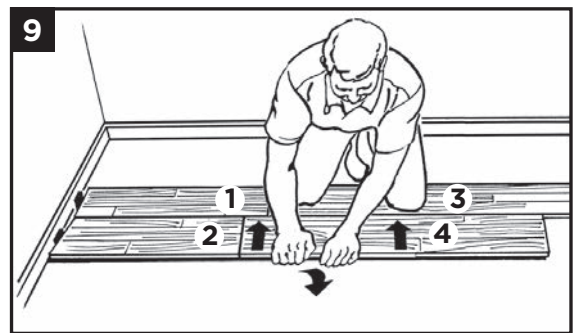
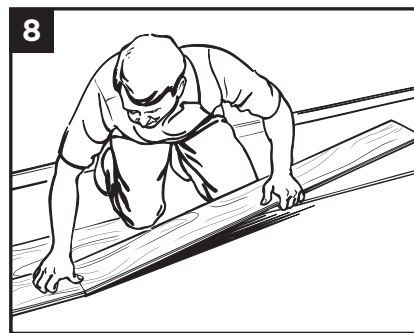
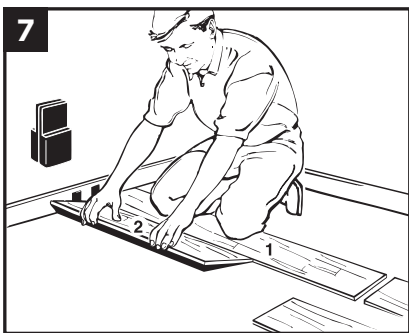
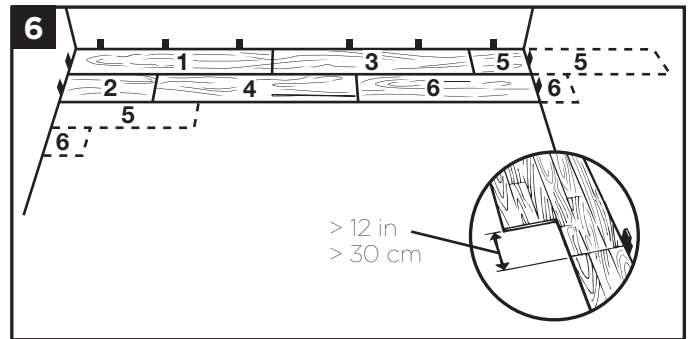
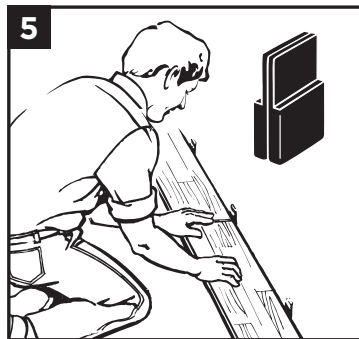
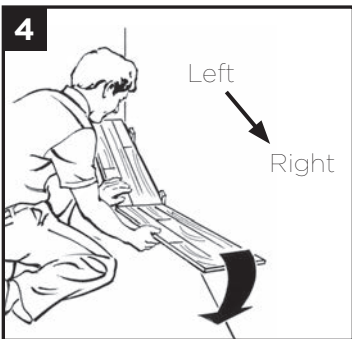
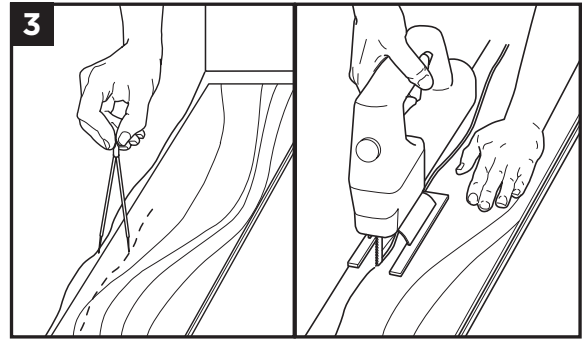
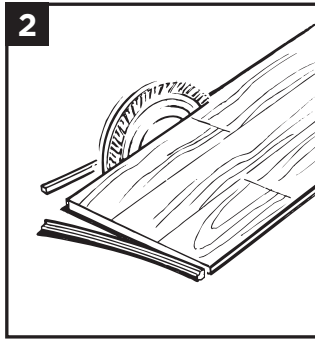
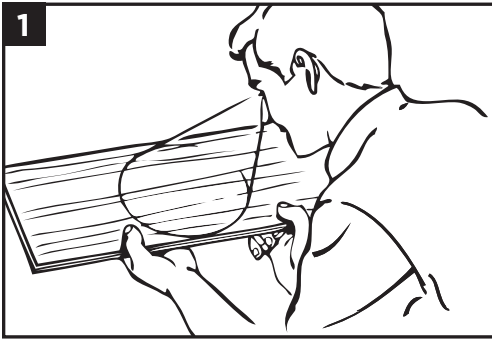

Traditional Living Flooring Install Instructions

Flooring Installation

1. Inspect each plank.
2. For the first row along straight walls, remove the tongue on all long side joints and on the short side of the 1st plank only.
3. For uneven walls, trace contour on tongue-side of plank and cut.
4. Assemble the first row tongue side toward wall. Insert the end tongue into the end groove and rotate downward to assemble. Keep the planks aligned and the joints closed.
5. Two spacers thick side to thick side = $\frac{3}{8}$ ".
6. Provide a $\frac{3}{8}$ " space for expansion on all sides. First piece must be at least 8" long. Start new rows with pieces trimmed from previous row. Ensure at least a 12" end joint offset.
7. At a slight angle, insert the tongue of plank 2 into the groove of plank 1 until the laminate edges meet, and then rotate down until the joints lock.
8. Join the short end of the plank first. There will be a gap on the long side joints when the plank is rotated down.
9. Raise the outside edge of the plank upward approximately 1". Maintain this angle as you push the plank in until the laminate edges meet. Rotate downward on the plank until the joint locks. Repeat these steps to complete the installation.

Installation Tip: Place a carton of planks across the end of the row being installed to keep installed planks in place during installation.

10. **Alternate Tap Method:** Align the tongues into the grooves of the long and short sides of the planks. Install the long side first by placing a tapping block no closer than 8" from either end and tap lightly along the long side until the joint is closed tightly. Then tap the end using the tapping block to into a locked position. **Note: Uneven tapping or use of excessive force may damage the joint.**
11. Ensure there will be a $\frac{3}{8}$ " gap (after the joint is closed) to the wall for expansion.
12. For the last row, align the plank to be used on top of the 2nd to last row. Using a full width plank as a spacer, trace wall contour and cut plank.
13. For the last row, install the long side tongue into the groove with the end joint aligned. Using a pull bar and hammer, work evenly along the length of the plank and lightly tap the joint closed.
14. After tapping the long side joint closed, tap the short side closed, using a tapping block or a pull bar.

Installation Under Doorway Frames

15. Slide plank under pre-cut door frame.
16. Tap the long side joint closed first. Then tap the end joint closed.

Installation Around Fixed Objects (such as Pipes)

17. Allow $\frac{3}{8}$ " expansion space around pipes or other fixed objects.

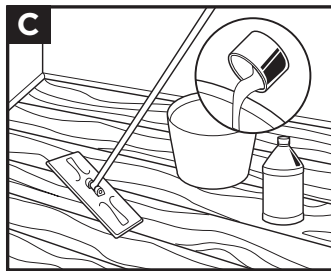
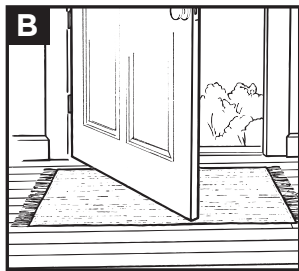

Care and Cleaning

- A) Place felt floor protectors under legs of moveable furniture. Chair casters should be rubber - not plastic or metal.
- B) Place walk-off mats at entrances.
- C) **Dust mop or damp mop only. NO wet mopping.** Use 1 cup of vinegar per gallon of water OR $\frac{1}{3}$ cup ammonia per gallon of water. Do not use abrasive cleaners, detergents, soaps, waxes or polishes. Use correct hard surface vacuum tools. **DO NOT** use rotating beater bars, floor scrubbers, steamers, jet mops or similar products. **DO NOT** allow liquids to stand on the floor. Wipe up spills immediately. **DO NOT allow moisture to be on the floor for longer than 30 minutes.**

Limited Lifetime* Residential Warranty

Traditional Living provides the following limited lifetime* residential warranty to the original purchaser for as long as he or she owns the flooring in its original installation: (1) the laminate surface will not wear through; (2) the floor will not fade due to sun or electrical light; (3) the floor will not stain; (4) the floor will resist damage from moisture due to damp mopping and everyday spills when removed promptly; and (5) the joint will remain secure under normal use conditions. This limited warranty is subject to the conditions described in the "Conditions" section below and does not apply if used in any commercial setting.

Traditional Living Limited 6-Month Manufacturing Warranty

Traditional Living provides a limited warranty to the original purchaser for six (6) months from the date of purchase covering any manufacturing defects in the flooring.

The Traditional Living Limited 6-Month Manufacturing Warranty is made subject to the following condition:

This limited warranty does not cover any damage that occurs during shipment or installation.

All areas must be assessed prior to installation of flooring to determine if other surface measures need to be taken or conditions addressed, including, but not limited to requirements for static control, state health and building codes, slip resistance, high impact traffic and moisture/water exposure. Other than the specific warranty identified above, Traditional Living provides no additional warranties and Traditional Living does not warrant that any of the uses identified above are in compliance with any applicable building, health, inspection, and/or other municipal regulation or codes. Traditional Living is not responsible for usage that is not in compliance with any regulation or code. Proper assessment of location and usage must be applied. Contact your Traditional Living representative for questions on performance in specific locations.

The Traditional Living Limited Lifetime* Residential Warranty is made subject to the following conditions:

- 1) The floor must be installed properly in accordance with Traditional Living installation instructions. The instructions should be obtained through a retailer or at 1-800-325-7062. Proper installation includes, but is not limited to, the following:
 - A moisture test must be performed to determine if excessive moisture exists in the subfloor.
 - When using a calcium chloride moisture test for concrete subfloors (ASTM 1869), values must be ≤ 5 lbs/1000ft²/24-hr or $<80\%$ with an in situ probe (ASTM F2170).
 - A polyethylene film vapor barrier is not required over wood subfloors. Moisture readings of wood subfloors must be $\leq 12\%$ throughout the entire installation.
 - For planks without attached underlayment, install over a single layer of underlayment appropriate for laminate floors.
 - When installing Traditional Living in special situation areas such as: terrazzo, pier and beam, radiant heating and to also learn how to properly acclimate your floor, please contact our consumer help line at 1-800-325-7062 to obtain important additional information.
- 2) The flooring must be used only indoors in a dry, climate-controlled area.
 - 3) The flooring must be maintained in accordance with Traditional Living care and cleaning instructions.
 - 4) Damage must not have occurred as a result of improper or inadequate maintenance or accidents, such as damage caused by scratching, impact or cutting. Damage resulting from the use of rotating beater bars, floor scrubbers, steamers, jet mops, buffers or similar products is not covered by this limited warranty.
 - 5) Surface wear must be readily visible (i.e. approximately 1 square inch). Gloss or sheen change and variations from later product additions or non-warranty repairs are not covered by these limited warranties.
 - 6) These limited warranties do not apply to water damage, including but not limited to water damage caused by flooding, standing water (water that remains on floor longer than 30 minutes), leaking pipes, mechanical failures, appliance leaks or pet urine.
 - 7) These limited warranties do not apply to damage caused by water or moisture in the subfloor or underneath the flooring, including but not limited to damage from subfloor hydrostatic pressure (water or moisture under the floor that is transmitted to the surface through exerted pressure) or other conditions that result in water or moisture being below the floor.

8) These limited warranties do not apply to flooring installed on a concrete subfloor unless a non-recycled (100% virgin resin) 6-mil polyethylene film vapor barrier with a density of 0.92 lbs/cubic foot and a thickness tolerance of +/- 10% is installed over the concrete subfloor that emits a water vapor no greater than 5 lbs/1000ft²/24-hr.

9) These limited warranties do not apply to moldings.

10) Installation of flooring that contains any manufacturing defect is not covered by these limited warranties.

* The warranty period is pro rata 33 years. A pro rata warranty is one that provides for a refund or credit that decreases according to a set formula as the warranty period progresses. The original warranty value is reduced by the amount of time that you own it. When a claim is made, the value of the warranty becomes a percentage of ownership based on 33 years. Any services provided as part of this warranty do not extend the original warranty period.

How to Make Claims:

Any claim under any of the limited warranties above must be made by contacting your retailer within 30 days after the basis for the claim is detected. In addition, any claim under any of the limited warranties above must be made before the end of the applicable limited warranty period. Proof of purchase, including the date of purchase, must be presented to make a claim.

Traditional Living's Responsibility:

If Traditional Living accepts a claim under any of the limited warranties above, Traditional Living will repair or replace, at its option, the affected Traditional Living flooring material only. Labor costs for removal and/or installation or repair associated with a warranty claim are not covered. If Traditional Living in its sole discretion determines that such repair or replacement is not reasonably achievable, Traditional Living may choose to refund the purchase price of the affected Traditional Living flooring material. If the design for which a claim is made is no longer available, Traditional Living will replace the affected floor materials with another Traditional Living design of equal or greater value at Traditional Living's discretion. Upon approval of the warranty claim, Traditional Living will provide you with instructions on the manner in which to proceed in order to have your flooring repaired or replaced, and you must comply with such instructions within ninety (90) days after the claim is approved or your rights under the limited warranty will be deemed waived. The above remedies are the sole and exclusive remedies for claims on this product. These limited warranties give you specific legal rights, and you may also have other rights which vary from State to State.

DISCLAIMERS: TRADITIONAL LIVING DISCLAIMS ALL OTHER EXPRESS OR IMPLIED WARRANTIES, INCLUDING ANY IMPLIED WARRANTY OF MERCHANTABILITY OR FITNESS FOR A PARTICULAR PURPOSE, WITH RESPECT TO THIS PRODUCT.

Traditional Living disclaims liability for incidental and consequential damages. Some States do not allow the exclusion or limitation of incidental or consequential damages, so the above limitation or exclusion may not apply to you.

These limited warranties are not transferable. They extend only to the original end-consumer.

Samples, descriptions, and other information concerning the product contained in Traditional Living catalogs, advertisements, or other promotional material or statements made by sales representatives or distributors are for general informational purposes only and are not binding upon Traditional Living. No sales representatives or distributors shall have any authority whatsoever to establish, expand or otherwise modify Traditional Living's warranties.

The provisions of these limited warranties are deemed to be severable and the invalidity or unenforceability of one provision shall not affect the validity or enforceability of any other provision. These limited warranties constitute the entire agreement of the parties, and no waiver or amendment shall be valid unless in writing and signed by an authorized representative of Traditional Living.

Care and Cleaning

Place felt floor protectors under the legs of moveable furniture. Chair casters should be rubber – not plastic or metal. Place walk-off mats at entrances. **Dust mop** as primary cleaning method. Occasionally damp mop with water only. **NO wet mopping.** If needed, use 1 cup of vinegar per gallon of water OR $\frac{1}{3}$ cup non-sudsing ammonia per gallon of water. **DO NOT** use detergents, abrasive cleaners, soaps, waxes or polishes. Use correct hard surface vacuum tools. **DO NOT** use rotating beater bars, floor scrubbers, steamers, jet mops, buffers or similar products. Wipe up spills immediately. **DO NOT allow moisture to remain on the floor for longer than 30 minutes.**