

LEGION

LEGION GAMING CHAIR C7

VSN# 52014DGRY

52015LGRY



Attention:

1. Do not stand on the seat cushion.
2. For indoor use only. Please do not expose to direct sunlight, sources of excessive heat, or use in wet or damp environments.
3. Do not allow children to play on or near this product.
4. Please avoid use of sharp objects on or near this product.
5. Clean spills / marks immediately, as stains are harder to remove when they are left unattended.
6. Only a damp cloth should be used to clean the upholstery surface. For persistent stains and overall cleaning, contact a professional upholstery cleaning company.
7. Do not use power tools. Only use the Allen Key provided. Check and re-tighten screws and knobs every 90 days.
8. The casters sold with this chair are intended for use on carpet and not recommended for use on tile or hard wood floors. Using these casters on tile or wood flooring may cause floor surface damage, so please consider purchasing a chairmat to protect your floor surfaces.

PARTS LIST

A



Casters X5

B



Base X1

C



Gas Lift X1

DL



Left Arm X1

DR



Right Arm X1

E



Back Cushion X1

F



Seat Cushion with
Seat Plate X1

G



Headrest X1

H



25mm Big Screws
(Hex Head) X3

I



25mm Big Screws
X2

J



38mm Big Screws
X2

K



16mm Small
Screws X1

L



Allen Key X1



Note: Do not use power tools. Only use the Allen Key provided.

ASSEMBLY

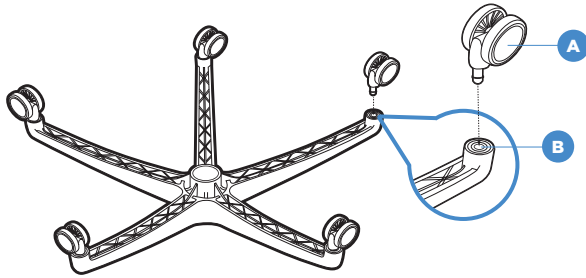

Step 1

Place the Base (B) upside down and insert 5 Casters (A) into the holes on the Base (B).

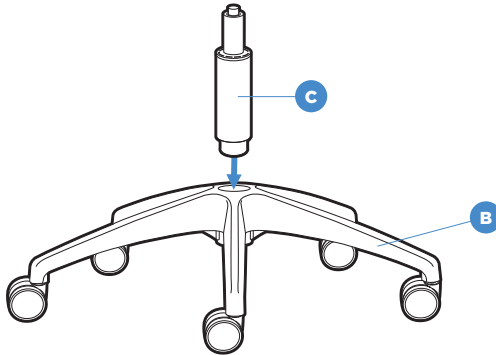

Step 2

Turn the Base (B) over and insert the Gas Lift (C) through the center hole on top of Base (B).

Step 3

Insert Back Cushion (E) into the rear hole of the seat plate as shown. Then secure with 25mm Big Screws (H). Note: Tighten the screws completely.

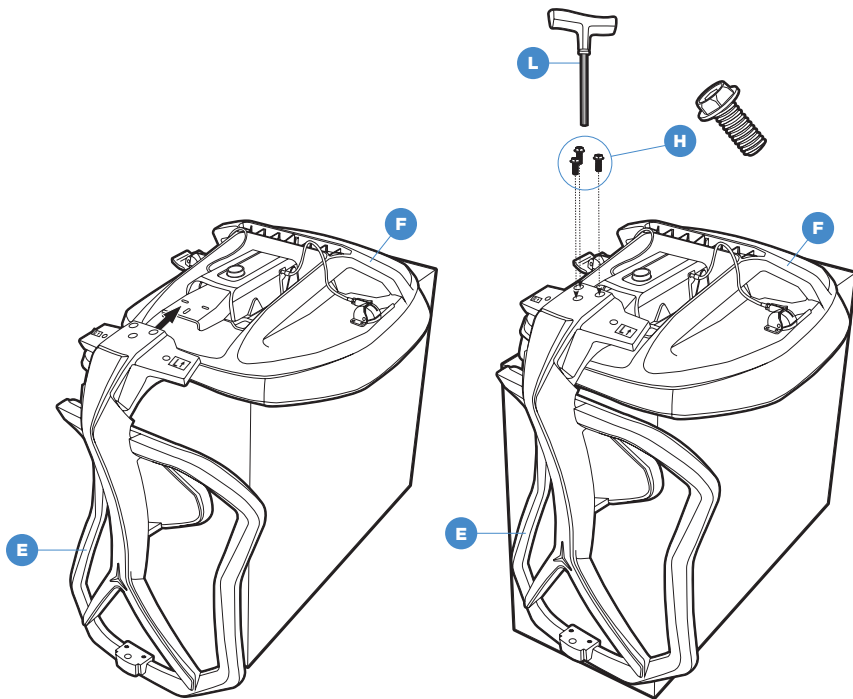

Step 4

Insert Arms (DL & DR) into the bottom of Back Cushion (E) as shown. Then secure with 38mm Big Screws (J) as shown.

Note: Assemble screw J first, then screw I. Tighten the screws completely.

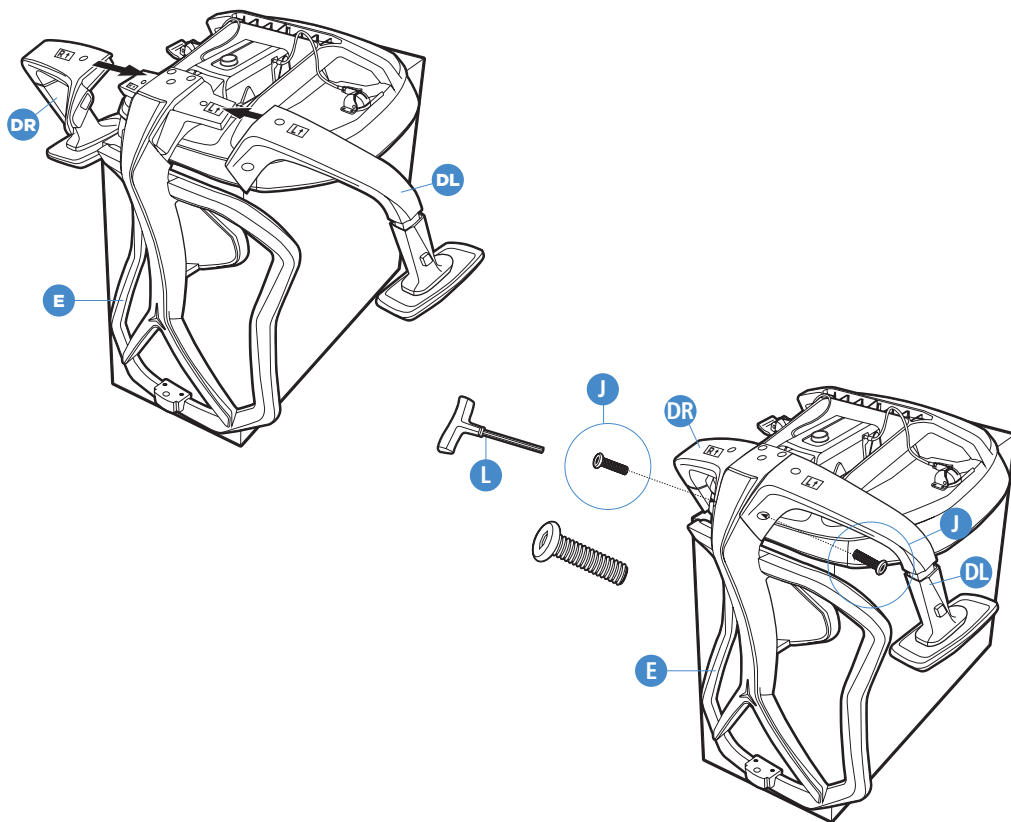

Step 5

Insert 25mm Big Screws (I) to the bottom of the arms as shown. Tighten the screws completely.

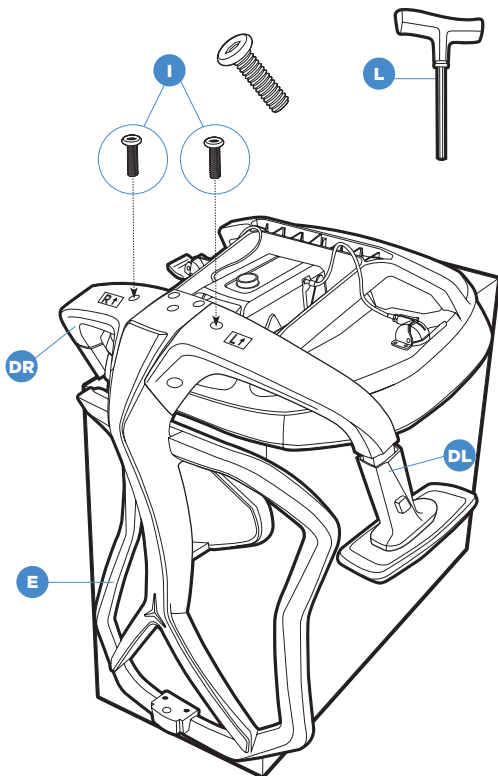

Step 6

Position the assembled chair upright with the seat plate facing down. Insert the Gas Lift (C) into the center hole of the seat plate. Push down firmly over the Gas Lift (C) until it is securely connected.



Step 7

Attach the Headrest (G) to the Back Cushion (E) by using 16mm Small Screws (K) as shown. Note: Tighten the screws completely.

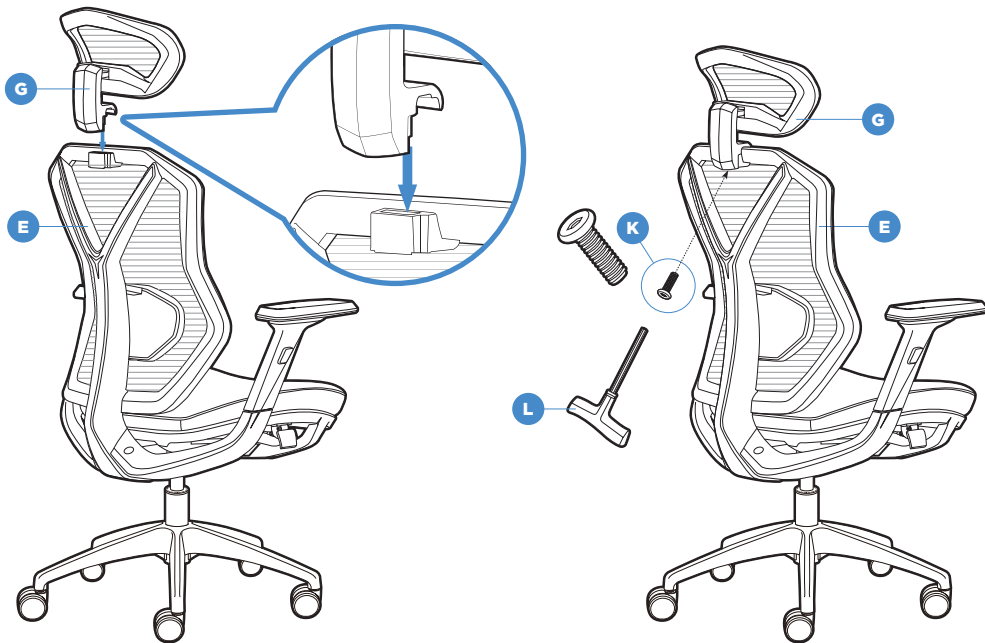

Function Instruction 1

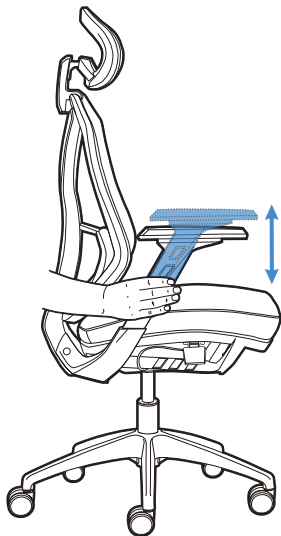

To Adjust Arm Height:

Press the buttons to allow the arms to move up or down freely then release the buttons once the desired height is reached.

Function Instruction 2

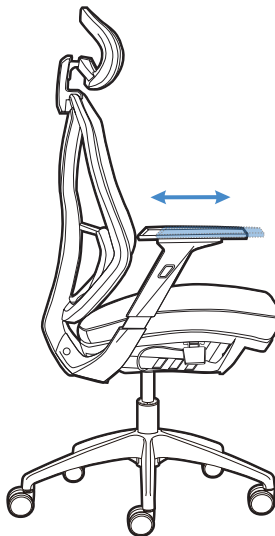

To Adjust Armrests Forward & Backward:

While seated, grasp the armrests and push them forward or backward to desired position.

Function Instruction 3

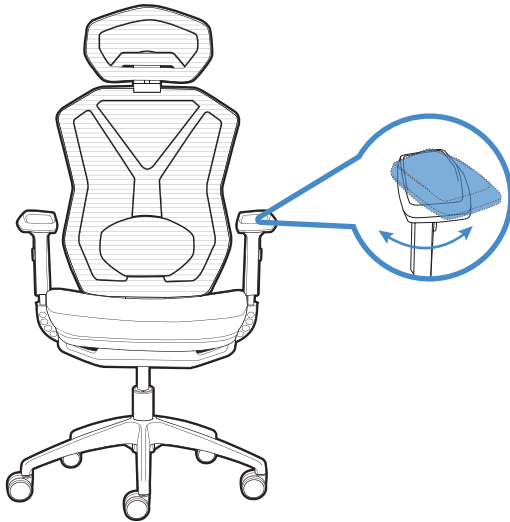

To Adjust Armrests Angle:

While seated, grasp front end of armrests and pivot them to the left or right. Adjusting arm angle can help support different types of work and shifts in posture.

Function Instruction 4



To Adjust Armrests Width:

While seated, hold and push the armrests outwards or inwards into a desired width of arms.

Function Instruction 5



To Adjust Headrest Height:
Headrest height adjust independently for the short and tall.

Function Instruction 6

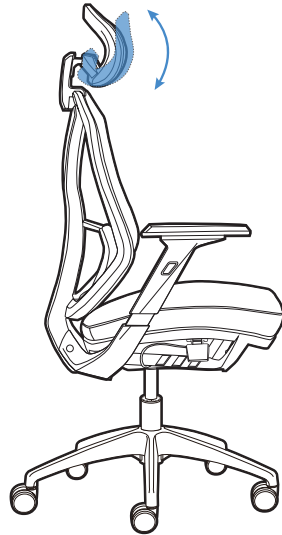

To Adjust Headrest Radian:
Swivel up and down for optimum neck comfort.

Function Instruction 7

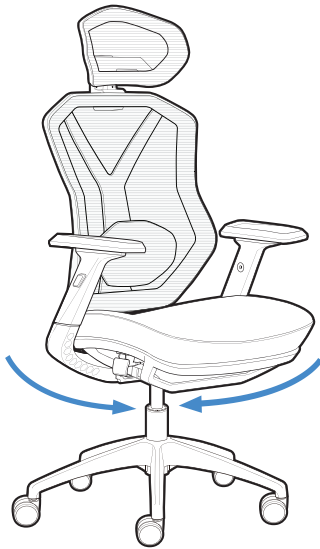

360° Swivel:

Allows the seat to swivel 360 degrees.

Function Instruction 8

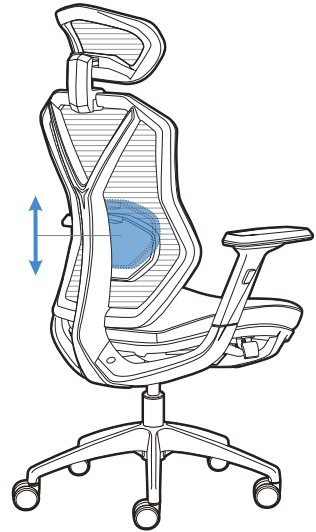

To Adjust Lumbar Support Height:

Lumbar support height adjust independently for the short and tall.

Function Instruction 9

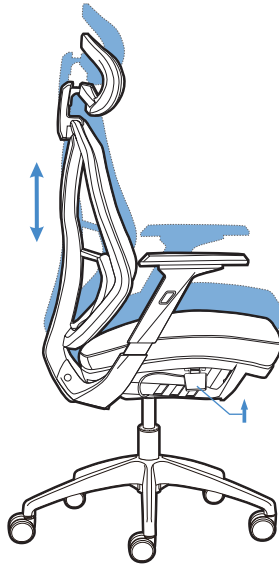

To Adjust Seat Height:

While seated, lean forward and reach under the right side of the chair to find the lever. Lift the lever and raise your body up slightly to allow the chair to rise to the desired height. Once desired height is reached, release lever to lock chair at desired height. To lower the seat, lift the lever while seated. The chair will descend until the lever is released or the chair reaches the bottom position.

Function Instruction 10

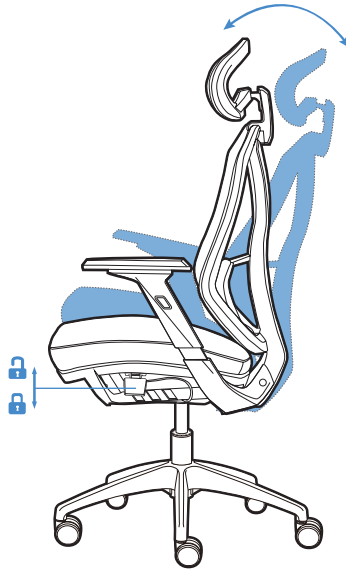

To Operate Tilt Lockout:

While seated, reach under the left side of the chair to find the lever. Pull up the lever and lean back to allow the chair to tilt backwards. Push the lever to the down position to lock the chair angle while the desired position is reached. Once you want to release the mechanism from the lock position, pull the lever upward (If pull the lever upward, apply more weight backward onto the back rest cushion and then release, the back rest cushion will come back to normal position.) Note: The force of the backrest can adjust automatically to the individual weight.

Limited Warranty

This limited warranty covers the original purchase of new product used for normal commercial, personal or household use. True Innovations seating products warrants its products will be free from defects in materials and workmanship (normal wear and tear excepted), for ten years from the date of purchase, except as provided below. True Innovations seating products, at its option, will replace with a comparable product, free of charge, any product purchased from it that fails under normal use as a result of such defect. This warranty does not apply to damage caused by fire, accident, negligence, misuse, use other than as stated in product instructions, improper cleaning or other circumstances not directly attributable to defects in materials and workmanship.

Natural variations occurring in plastic or other materials will not be considered defects, and True Innovations seating products does not warrant the color-fastness or matching of colors, grains, or textures of such materials. This warranty does not apply to: modifications of the product, attachments to the product not approved by True Innovations seating products, and products that were not installed, used, or maintained in accordance with product instructions and warnings.

This warranty has the following exceptions: Fabrics, foam, and other covering materials are warranted for three years from date of purchase.

Proof of purchase is required in the form of a receipt (copy or original) to validate warranty. Warranty claims without the receipt may be rejected.

TRUE INNOVATIONS SEATING PRODUCTS PROVIDES THIS LIMITED WARRANTY IN LIEU OF ALL OTHER WARRANTIES EITHER EXPRESSED OR IMPLIED. EXPRESSLY EXCLUDED ARE ALL WARRANTIES OF FITNESS FOR A PARTICULAR PURPOSE OR MERCHANTABILITY. OFFICE DEPOT'S SOLE OBLIGATION AND THE USER'S EXCLUSIVE REMEDY UNDER THIS WARRANTY SHALL BE LIMITED TO THE REPAIR, REFUND (IN THE FORM OF AN OFFICE DEPOT MERCHANDISE CARD) OR REPLACEMENT AT TRUE INNOVATIONS SEATING PRODUCTS'S SOLE DISCRETION AND COST, OF PRODUCT OR COMPONENTS.

IN NO EVENT SHALL TRUE INNOVATIONS SEATING PRODUCTS, ITS AFFILIATES, SUBSIDIARIES OR PARENT COMPANIES BE RESPONSIBLE FOR CONSEQUENTIAL, SPECIAL, OR INCIDENTAL DAMAGES ARISING OUT OF A CLAIM OF DEFECTIVE PRODUCT EVEN IF TRUE INNOVATIONS SEATING PRODUCTS HAS BEEN ADVISED OF THE POSSIBILITY OF SUCH DAMAGES.

SOME STATES OR PROVINCES DO NOT ALLOW THE EXCLUSION OF IMPLIED WARRANTIES OR LIMITATIONS ON HOW LONG AN IMPLIED WARRANTY LASTS OR THE EXCLUSION OR LIMITATION OF INCIDENTAL OR CONSEQUENTIAL DAMAGES SO THE ABOVE LIMITATIONS MAY NOT APPLY TO YOU. THIS WARRANTY GIVES YOU SPECIFIC LEGAL RIGHTS, AND YOU MAY ALSO HAVE OTHER RIGHTS WHICH MAY VARY BY STATE OR PROVINCE.

THIS WARRANTY APPLIES ONLY TO THE U.S.

Service Instructions

Please call: 1-800-379-9773 for warranty service.