



# **Assembly Instructions & User's Manual**

for

## ***Member's Mark 2PK Padded Wicker Chaise***

**Model Number: FBM16008**

**Customer Assistance (spare/replacement parts): 1-888-690-9800**

**or Email: [cs@sunvillahome.com](mailto:cs@sunvillahome.com)**

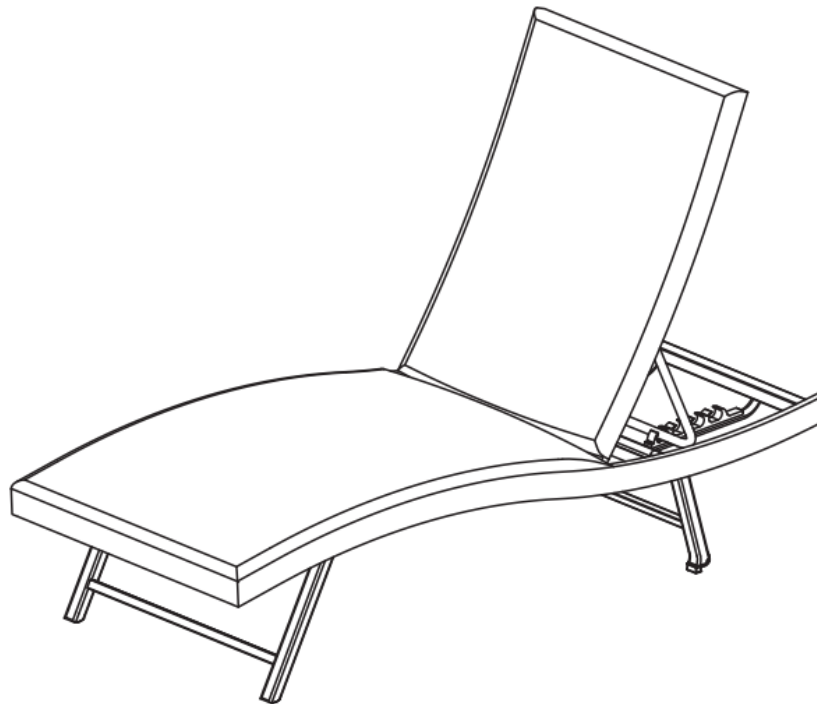

THIS ASSEMBLY MANUAL CONTAINS IMPORTANT SAFETY INFORMATION.  
PLEASE READ AND KEEP FOR FUTURE REFERENCE.

# Table of Contents

Quality Statement.....	3
Important Safety Information .....	3
Before Assembly .....	3
Care & Use .....	3
Package Contents .....	4
Product Information .....	5
Step 1 – Step 2 .....	5
Storage Instructions.....	7
Technical Data .....	7
Warranty Information .....	7

# Quality Statement

## Questions or Comments?

We would love to hear about your Member's Mark experience! Visit us at:  
[samsclub.com/membersmarkhelp](https://samsclub.com/membersmarkhelp)

## Important Safety Information

- *Please read all instructions carefully before assembling this product.*
- *Where applicable, and for your safety, assembly by an adult is strongly recommended.*
- *Use only vendor-supplied hardware to assemble this item. Using unauthorized hardware could jeopardize the structural integrity of the item.*
- *Hardware may loosen overtime. Periodically check that all connections are tight.*

## Before Assembly

- *Remove all parts and hardware from the box. Place all items on a carpeted or scratch-free work surface, as this will avoid damaging parts during assembly.*
- *The shipping box can provide an ideal work surface if none is available.*
- *Use the components and hardware lists below to identify, inventory and separate each of the hardware and components included.*
- *To avoid accidentally discarding small components or hardware, do not dispose of any packaging or contents of the shipping carton until assembly is complete.*
- ***DO NOT USE*** power tools unless it is explicitly identified in this manual as required for use during assembly. Power tools can damage the fasteners, hardware and/or components.
- *Do not fully tighten all fasteners / screws until all parts are in place. Failure to follow these instructions may cause the fasteners / screws to misalign during assembly.*

## Care & Use

- *Use a soft, clean cloth that will not scratch the surface when cleaning.*
- *Dust often and use a vacuum cleaner crevice tool to clean between seams.*
- *Keep furniture at least 60cm/2ft from heat sources to avoid damage.*

# Package Contents

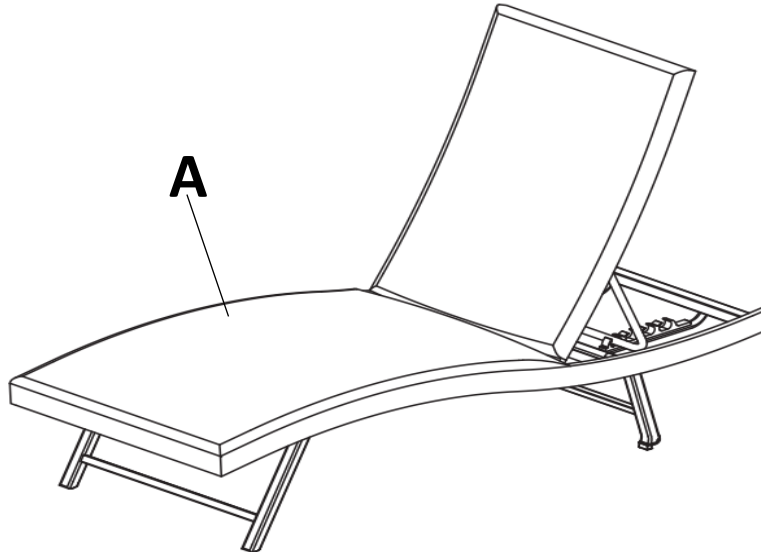

Component	Description	Quantity		Component	Description	Quantity
A	Wicker Chaise	2				

*Need Assistance? Visit us at: [samsclub.com/membersmarkhelp](https://www.samsclub.com/membersmarkhelp)*

# Product Information

Dimensions: **27.75"x77.75"x15.5"** (70.5cm x 197.5cm x 39.5cm)

Weight Capacity: **Supports up to 250 lbs. (113.4kg.)**

## Step 1 – Step 2

Step 1

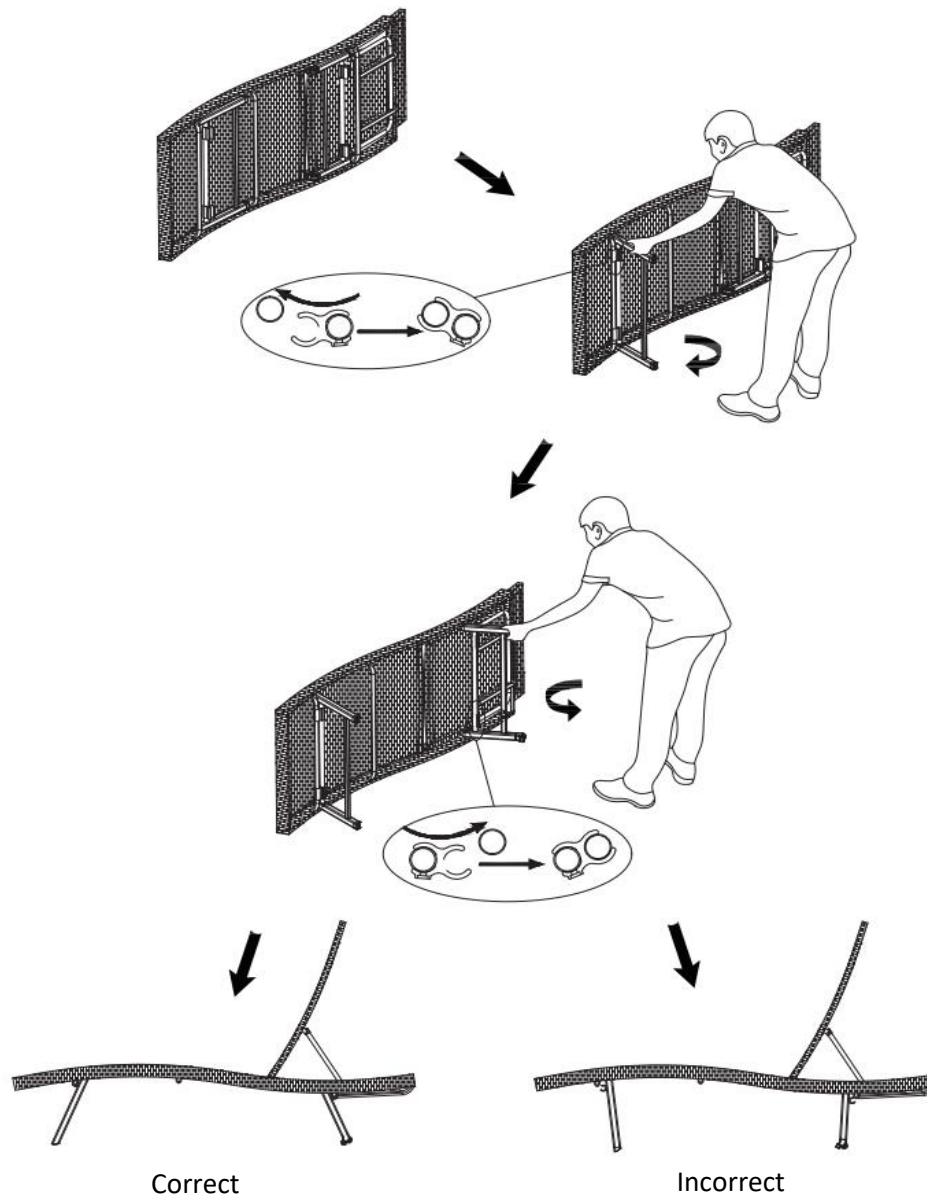

*Need Assistance? Visit us at: [samsclub.com/membersmarkhelp](https://www.samsclub.com/membersmarkhelp)*

Step 2

Adjust the backrest to the desired angle.

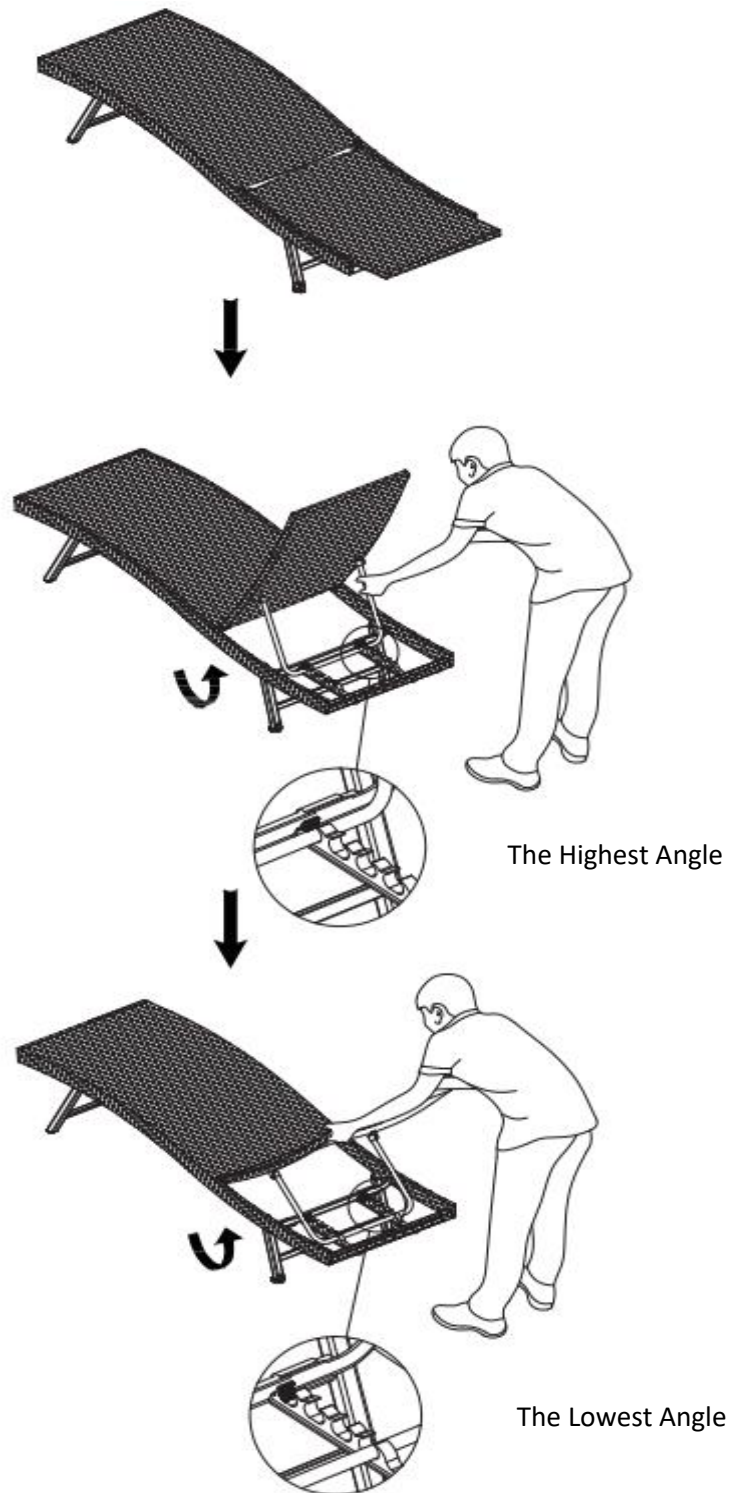

Need Assistance? Visit us at: [samsclub.com/membersmarkhelp](https://www.samsclub.com/membersmarkhelp)

# Storage Instructions

- |   |
|---|
| 1. Carefully place all components into shipping box and/or provided container tape it shut. |
| 2. When not in use, please store your item in a cool, dry place away from sunlight.         |
| 3. Exposing your item to excessive heat or humidity may damage your item.                   |

## Technical Data

Aluminum: 6063

Steel: Q235

## Warranty Information

This product component has a 3 years guarantee against defects in material and/or workmanship. If you have any questions regarding the warranty or spare / replacement parts, please call our toll-free number 1-888-690-9800 or email us at [cs@sunvillahome.com](mailto:cs@sunvillahome.com)

**NOTE:** Please consider recycling all applicable packaging material.

**Distributed by Sam's West Inc.**  
2101 SE Simple Savings Dr.  
Bentonville, Arkansas 72716-0745

Made in China



*Need Assistance? Visit us at: [samsclub.com/membersmarkhelp](https://samsclub.com/membersmarkhelp)*