

QUICK SET-UP GUIDE

Solar String Lights

DUSK TO DAWN FUNCTION & BULBS

- 1) Turn the solar panel to the ON position.
- 2) Turn the solar panel over so no light shines on the glass (you can also cover the panel with a towel or delicate fabric).
- 3) With the panel covered, completely cover the receiver. Once the panel and receiver are totally covered, the lights should now illuminate.
- 4) Should a bulb not illuminate, unscrew and remove that bulb completely. Rescrew as tight as possible until the bulb illuminates.

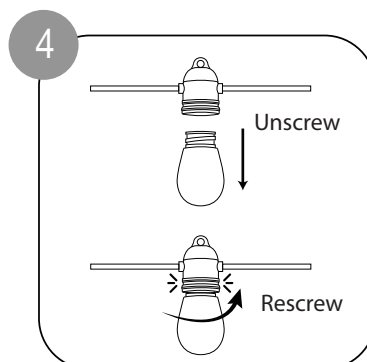
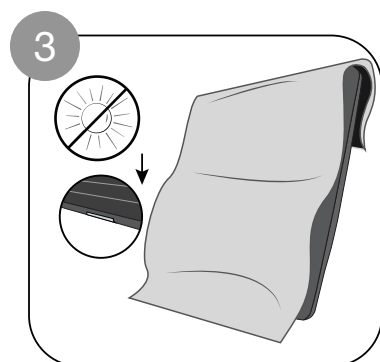
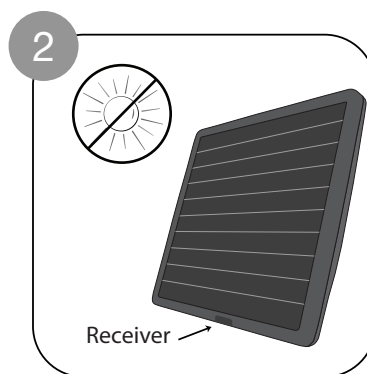
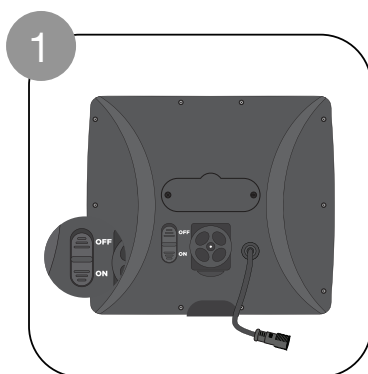

** Bulbs must be tighten